

**NOTICE!!**

**These documents have been scanned!**

**Do not place un-scanned documents beneath this notice!**

**Do not remove this notice from this file!**

GPO Jacket No. 560-102  
Print Order 61540  
Rise Business Services, LLC  
Job=AZ15 5/13/2019



Box Number= AZ15040



Claim Begin-End: AMC423142-AMC423144

1 Initial Receipt



AZ15040-19

AMC422569-AMC423150

**United States Department of the Interior**  
**Bureau of Land Management**  
 LANDS/RECREATION & PLANNING  
 ONE N CENTRAL AVE  
 PHOENIX, AZ 85004 -2203  
 Phone: 602-417-9200

Receipt

No: 2796637

<b>Transaction #:</b> 2881471		<b>ENTERED INTO COMPUTER</b>
<b>Date of Transaction:</b> 05/20/2013		
CUSTOMER:		JUN 17 2013 <i>JB</i>
DEPARTMENT OF LAND TRANSFER INFORMATION 942 CALLE AMANECER STE B SAN CLEMENTE, CA 92673-6220 US		

LINE #	QTY	DESCRIPTION	REMARKS	UNIT PRICE	TOTAL
1	3.00	LOCATABLE MINERALS / MINING CLAIMS-NEW, UNADJUD, ONE OR MORE AUTH NOS / NEW MINING CLAIM LOCATION FEE \$34 <b>CASES:</b> AMC423142/\$34.00, AMC423143/\$34.00, AMC423144/\$34.00		- n/a -	102.00
2	3.00	LOCATABLE MINERALS / MINING CLAIMS-NEW, UNADJUD, ONE OR MORE AUTH NOS / NEW MINING CLAIM PROCESSING FEE \$15 <b>CASES:</b> AMC423142/\$15.00, AMC423143/\$15.00, AMC423144/\$15.00		- n/a -	45.00
3	3.00	LOCATABLE MINERALS / MINING CLAIMS-NEW, UNADJUD, ONE OR MORE AUTH NOS / NEW MINING CLAIM MAINT FEE \$140 <b>CASES:</b> AMC423142/\$140.00, AMC423143/\$140.00, AMC423144/\$140.00		- n/a -	420.00
<b>TOTAL:</b>					<b>\$567.00</b>

PAYMENT INFORMATION			
1	AMOUNT:	567.00	POSTMARKED: 05/17/2013
	TYPE:	CHECK	RECEIVED: 05/17/2013
	CHECK NO:	4822	
	NAME:	DEPARTMENT OF LAND TRANSFER INFORMATION 942 CALLE AMANECER STE B SAN CLEMENTE CA 92673-6220 US	

REMARKS

This receipt was generated by the automated BLM Collections and Billing System and is a paper representation of a portion of the official electronic record contained therein.

**NOTICE!!**

**These documents have been scanned!**

**Do not place un-scanned documents beneath this notice!**

**Do not remove this notice from this file!**

GPO Jacket No. 560-102  
Print Order 61540  
Rise Business Services, LLC  
Job=AZ15 5/13/2019



Box Number= AZ15040



Claim Begin-End: AMC423142-AMC423144

2 Correspondence



AZ15040-19

AMC422569-AMC423150



# United States Department of the Interior



BUREAU OF LAND MANAGEMENT  
Arizona State Office  
One North Central Avenue, Suite 800  
Phoenix, Arizona 85004-4427  
[www.blm.gov/az/](http://www.blm.gov/az/)

DEC 14 2017

In Reply Refer To:

3830 (9200) PB

AMC421163, AMC421606, AMC423142

CERTIFIED MAIL - RETURN RECEIPT REQUESTED No. 7016 2140 0000 1629 3008

## DECISION

PATRICK & R DEAN HARRELL & LA PILAR LLC : This decision affects those claims shown  
5615 POTTERS RD : in the block below.  
MATTHEWS, NC 28104-0508 :

---

AMC421164, AMC421610, AMC423142  
COCHISE, OLD CROW, BUTCH

---

### MINING CLAIMS DECLARED FORFEITED

The mining claims listed above have been declared forfeited as of September 1, 2017, for failure to timely file the required maintenance fee payment or small miner's maintenance fee waiver (waiver).

Claimants are required to pay an annual non-refundable maintenance fee of \$155 per 20 acres or portion thereof, or submit a waiver, on or before September 1 of each year. These requirements were established by 30 U.S.C. 28f-1, as amended, and 43 CFR 3834 and 3835.

Our records do not show receipt of a maintenance fee payment or small miner waiver filed on or before the due date. Therefore, the claims listed above are forfeited.

### Reclamation Requirements

This decision does not relieve you of the liability for reclamation of all areas disturbed by your activities on lands covered by the subject mining claim(s) and/or site(s). After you complete the reclamation, you must notify the authorized officer of the appropriate surface managing agency so that the authorized officer may conduct a final site inspection and determine whether you may be released from liability. If you fail to reclaim the land to the satisfaction of the authorized officer,

the surface management agency may cite you for noncompliance under its surface management regulations. For land administered by the Bureau of Land Management (BLM), if you fail to reclaim the land to the satisfaction of the authorized officer as required in 43 CFR Subpart 3809, BLM will issue an order of noncompliance under 43 CFR 3809.601(a). If you fail to comply with the non-compliance order, BLM may take further action under 43 CFR 3809.604. Failure to conduct reclamation is a prohibited act that may subject you to criminal penalties. See 43 CFR 3809.605(h) and 43 CFR 3809.700.

### Appeal Procedures

This decision may be appealed to the Interior Board of Land Appeals, Office of the Secretary, in accordance with the regulations contained in 43 CFR, Part 4, and the enclosed Form 1842-1. If an appeal is taken, your notice of appeal must be filed in this office (at the above address) within 30 days from receipt of this decision. The appellant has the burden of showing that the decision appealed from is in error.

If you wish to file a petition pursuant to regulation 43 CFR 4.21 (58 FR 4939, January 19, 1993) for a stay of the effectiveness of this decision during the time that your appeal is being reviewed by the Board, the petition for a stay must accompany your notice of appeal. A petition for a stay is required to show sufficient justification based on the standards listed below. Copies of the notice of appeal and petition for a stay **must** also be submitted to each party named in this decision and to the Interior Board of Land Appeals and to the appropriate Office of the Solicitor (see 43 CFR 4.413) at the same time the original documents are filed with this office. If you request a stay, you have the burden of proof to demonstrate that a stay should be granted.

### Standards for Obtaining a Stay

Except as otherwise provided by law or other pertinent regulation, a petition for a stay of a decision pending appeal shall show sufficient justification based on the following standards:

- (1) The relative harm to the parties if the stay is granted or denied,
- (2) The likelihood of the appellant's success on the merits,
- (3) The likelihood of immediate and irreparable harm if the stay is not granted, and
- (4) Whether the public interest favors granting the stay.

Please include your AMC serial number(s) on all correspondence. If additional information is required, please call Pauline Brown at 602-417-9360.

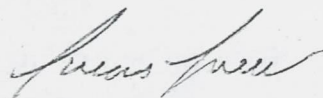

Lucas Lucero  
Deputy State Director  
Lands, Minerals, and Energy Division

Enclosure

**SENDER: COMPLETE THIS SECTION**

- Complete items 1, 2, and 3.
- Print your name and address on the reverse so that we can return the card to you.
- Attach this card to the back of the mailpiece, or on the front if space permits.

1. Article Addressed to:

PATRICK & R DEAN HARRELL & LA PILAR  
 LLC  
 5615 POTTERS RD  
 MATTHEWS, NC 28104-0508  
 9200 PB AMC421163, AMC421606, AMC423142



9590 9402 2630 6336 1247 07

2. Article Number (Transfer from service label)

7016 2140 0000 1629 3008

**COMPLETE THIS SECTION ON DELIVERY**

A. Signature

X *[Signature]*

Agent

Addressee

B. Received by (Printed Name)

C. Date of Delivery

12/11/15

7. Is delivery address different from item 1?  Yes

If YES, enter delivery address below:  No

3. Service Type

Adult Signature

Adult Signature Restricted Delivery

Certified Mail®

Certified Mail Restricted Delivery

Collect on Delivery

Collect on Delivery Restricted Delivery

Mail

Mail Restricted Delivery

(over 500)

Priority Mail Express®

Registered Mail™

Registered Mail Restricted Delivery

Return Receipt for Merchandise

Signature Confirmation™

Signature Confirmation Restricted Delivery

USPS TRACKING#

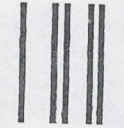
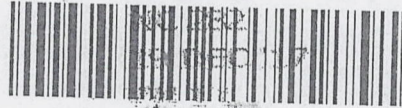

First-Class Mail  
Postage & Fees Paid  
USPS  
Permit No. G-10

9590 9402 2630 5336 1247 07

United States  
Postal Service

RECEIVED  
BLM AZ STATE OFFICE

2017 DEC 26 A 8  
PHOENIX ARIZONA  
Sender: Please print your name, address, and ZIP+4® in this box®  
U.S. DEPARTMENT OF THE INTERIOR  
BUREAU OF LAND MANAGEMENT  
ARIZONA STATE OFFICE  
ONE NORTH CENTRAL AVENUE, SUITE 800  
PHOENIX, AZ 85004-4427

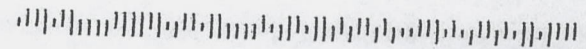





# United States Department of the Interior



BUREAU OF LAND MANAGEMENT  
Arizona State Office  
One North Central Avenue, Suite 800  
Phoenix, Arizona 85004-4427  
www.blm.gov/az/

FEB 26 2015

In Reply Refer To:  
3800 (9310) PB  
AMC423142

CERTIFIED MAIL - RETURN RECEIPT REQUESTED No. 7014 0150 0000 5423 1562

## DECISION

DOUGLAS DIAMONDS CORP  
1300 N CHARLOTTE ST  
POTTSTOWN, PA 19464-2651

: The block below contains a list of the claims  
: affected.  
:

---

AMC423144  
SAMOA EAST

---

### MINING CLAIMS DECLARED FORFEIT

The mining claims listed above have been declared forfeit for failure to file the required Notice of Intent to Hold (NOI) on or before December 30, 2014.

A small miner's maintenance fee waiver certification was filed for these claims for the 2015 assessment year, which began on September 1, 2014. Therefore, pursuant to regulations found at 43 CFR 3835.15 and 3835.31, an NOI must have been filed on or before December 30, 2014, along with a \$10 processing fee per claim. Failure to timely file this NOI and fee constitutes a forfeiture of the claims (43 CFR 3835.91).

### Reclamation Requirements

You are required to reclaim all areas disturbed by your activities on lands encompassed by your mining claim(s) and/or site(s). After you complete the reclamation, you must notify the authorized officer of the appropriate surface managing agency so that the authorized officer may conduct a final site inspection and determine whether you may be released from liability. If you fail to reclaim the land to the satisfaction of the authorized officer, the surface management agency may cite you for noncompliance under its surface management regulations.

For land administered by the Bureau of Land Management (BLM), if you fail to reclaim the land to the satisfaction of the authorized officer as required in 43 CFR Subpart 3809, BLM will issue an order of noncompliance under 43 CFR 3809.601(a). If you fail to comply with the noncompliance

*See 2014 W/PA  
Last known address*

*Claim closed on 4/23/15 - BB  
RJS - Not deliverable as Addressed UNABLE TO FORWARD.  
Last known Address - PA*

order, BLM may take further action under 43 CFR 3809.604. Failure to conduct reclamation is a prohibited act that may subject you to criminal penalties. See 43 CFR 3809.605(h) and 43 CFR 3809.700.

### Appeal Procedures

This decision may be appealed to the Interior Board of Land Appeals, Office of the Secretary, in accordance with the regulations contained in 43 CFR, Part 4 and the enclosed Form 1842-1. If an appeal is taken, your notice of appeal must be filed in this office (at the above address) within 30 days from receipt of this decision. The appellant has the burden of showing that the decision appealed from is in error.

If you wish to file a petition pursuant to regulation 43 CFR 4.21 (58 FR 4939, January 19, 1993) for a stay of the effectiveness of this decision during the time that your appeal is being reviewed by the Board, the petition for a stay must accompany your notice of appeal. A petition for a stay is required to show sufficient justification based on the standards listed below. Copies of the notice of appeal and petition for a stay **must** also be submitted to each party named in this decision and to the Interior Board of Land Appeals and to the appropriate Office of the Solicitor (see 43 CFR 4.413) at the same time the original documents are filed with this office. If you request a stay, you have the burden of proof to demonstrate that a stay should be granted.

### Standards for Obtaining a Stay

Except as otherwise provided by law or other pertinent regulation, a petition for a stay of a decision pending appeal shall show sufficient justification based on the following standards:

- (1) The relative harm to the parties if the stay is granted or denied,
- (2) The likelihood of the appellant's success on the merits,
- (3) The likelihood of immediate and irreparable harm if the stay is not granted, and
- (4) Whether the public interest favors granting the stay.

Please include your AMC serial number(s) on all correspondence. If additional information is required, please contact Pauline Brown at 602-417-9360.

Sincerely,

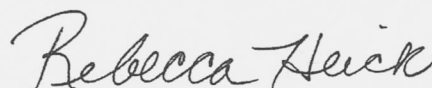

Rebecca Heick  
Acting Deputy State Director  
Lands and Minerals Division

Enclosure

UNITED STATES  
DEPARTMENT OF THE INTERIOR  
Bureau of Land Management  
Arizona State Office  
1 North Central Avenue, Suite 800  
Phoenix, Arizona 85004

Official Business  
Penalty for Private Use, \$300

PHOENIX, ARIZONA OFFICE

2015 MAR 12 P 3:00

PHOENIX, ARIZONA

*(Handwritten: JHP)*

DOUGLAS DIAMONDS CORP  
1300 N CHARLOTTE ST  
POTTSTOWN PA 19464-2351

DD = 4/11/15

19464-2351 ZC0

CERTIFIED MAIL™

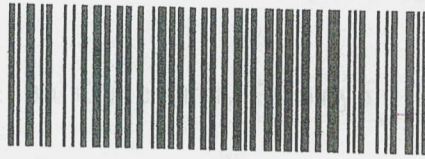

7014 0150 0000 5423 1562

neopost  
02/27/2015  
US POSTAGE



FIRST-CLASS MAIL

\$06.69<sup>0</sup>

US OFFICIAL MAIL  
\$300 Penalty  
For Private Use  
ZIP 85004  
041L11101433

99  
4-11-15

NIXIE 176 DE 1009 0003/08/15

RETURN TO SENDER  
NOT DELIVERABLE AS ADDRESSED  
UNABLE TO FORWARD

BC: 85004442700 \*0614-01259-02-39



PLACE STICKER AT TOP OF ENVELOPE TO THE RIGHT  
OF THE RETURN ADDRESS, FOLD AT DOTTED LINE

SENDER: COMPLETE THIS SECTION	COMPLETE THIS SECTION ON DELIVERY	
<ul style="list-style-type: none"><li>■ Complete items 1, 2, and 3. Also complete item 4 if Restricted Delivery is desired.</li><li>■ Print your name and address on the reverse so that we can return the card to you.</li><li>■ Attach this card to the back of the mailpiece, or on the front if space permits.</li></ul>	A. Signature <b>X</b> <input type="checkbox"/> Agent <input type="checkbox"/> Addressee	
1. Article Addressed to:  DOUGLAS DIAMONDS CORP 1300 N CHARLOTTE ST POTTSTOWN PA 19464-2351 ADJ/PB/AMC413935, AMC423142	B. Received by ( <i>Printed Name</i> )	C. Date of Delivery
2. Article Number <i>(Transfer from service label)</i>	D. Is delivery address different from item 1? <input type="checkbox"/> Yes If YES, enter delivery address below: <input type="checkbox"/> No	
	3. Service Type <input type="checkbox"/> Certified Mail® <input type="checkbox"/> Priority Mail Express™ <input type="checkbox"/> Registered <input type="checkbox"/> Return Receipt for Merchandise <input type="checkbox"/> Insured Mail <input type="checkbox"/> Collect on Delivery	
	4. Restricted Delivery? ( <i>Extra Fee</i> ) <input type="checkbox"/> Yes	
	7014 0150 0000 5423 1562	

PS Form 3811, July 2013

Domestic Return Receipt



# United States Department of the Interior



## BUREAU OF LAND MANAGEMENT

Arizona State Office

One North Central Avenue, Suite 800

Phoenix, Arizona 85004-4427

[www.blm.gov/az/](http://www.blm.gov/az/)

FEB 26 2015

In Reply Refer To:  
3800 (9310) PB  
AMC423142

CERTIFIED MAIL - RETURN RECEIPT REQUESTED No. 7014 0150 0000 5423 1562

### DECISION

DOUGLAS DIAMONDS CORP  
1300 N CHARLOTTE ST  
POTTSTOWN, PA 19464-2651

: The block below contains a list of the claims  
: affected.  
:

---

AMC423144  
SAMOA EAST

---

### MINING CLAIMS DECLARED FORFEIT

The mining claims listed above have been declared forfeit for failure to file the required Notice of Intent to Hold (NOI) on or before December 30, 2014.

A small miner's maintenance fee waiver certification was filed for these claims for the 2015 assessment year, which began on September 1, 2014. Therefore, pursuant to regulations found at 43 CFR 3835.15 and 3835.31, an NOI must have been filed on or before December 30, 2014, along with a \$10 processing fee per claim. Failure to timely file this NOI and fee constitutes a forfeiture of the claims (43 CFR 3835.91).

### Reclamation Requirements

You are required to reclaim all areas disturbed by your activities on lands encompassed by your mining claim(s) and/or site(s). After you complete the reclamation, you must notify the authorized officer of the appropriate surface managing agency so that the authorized officer may conduct a final site inspection and determine whether you may be released from liability. If you fail to reclaim the land to the satisfaction of the authorized officer, the surface management agency may cite you for noncompliance under its surface management regulations.

For land administered by the Bureau of Land Management (BLM), if you fail to reclaim the land to the satisfaction of the authorized officer as required in 43 CFR Subpart 3809, BLM will issue an order of noncompliance under 43 CFR 3809.601(a). If you fail to comply with the noncompliance

RTS  
DD 4/11/15

order, BLM may take further action under 43 CFR 3809.604. Failure to conduct reclamation is a prohibited act that may subject you to criminal penalties. See 43 CFR 3809.605(h) and 43 CFR 3809.700.

### Appeal Procedures

This decision may be appealed to the Interior Board of Land Appeals, Office of the Secretary, in accordance with the regulations contained in 43 CFR, Part 4 and the enclosed Form 1842-1. If an appeal is taken, your notice of appeal must be filed in this office (at the above address) within 30 days from receipt of this decision. The appellant has the burden of showing that the decision appealed from is in error.

If you wish to file a petition pursuant to regulation 43 CFR 4.21 (58 FR 4939, January 19, 1993) for a stay of the effectiveness of this decision during the time that your appeal is being reviewed by the Board, the petition for a stay must accompany your notice of appeal. A petition for a stay is required to show sufficient justification based on the standards listed below. Copies of the notice of appeal and petition for a stay **must** also be submitted to each party named in this decision and to the Interior Board of Land Appeals and to the appropriate Office of the Solicitor (see 43 CFR 4.413) at the same time the original documents are filed with this office. If you request a stay, you have the burden of proof to demonstrate that a stay should be granted.

### Standards for Obtaining a Stay

Except as otherwise provided by law or other pertinent regulation, a petition for a stay of a decision pending appeal shall show sufficient justification based on the following standards:

- (1) The relative harm to the parties if the stay is granted or denied,
- (2) The likelihood of the appellant's success on the merits,
- (3) The likelihood of immediate and irreparable harm if the stay is not granted, and
- (4) Whether the public interest favors granting the stay.

Please include your AMC serial number(s) on all correspondence. If additional information is required, please contact Pauline Brown at 602-417-9360.

Sincerely,

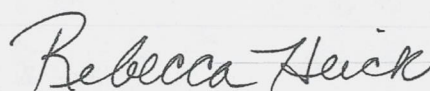

Rebecca Heick  
Acting Deputy State Director  
Lands and Minerals Division

Enclosure

**NOTICE!!**

**These documents have been scanned!**

**Do not place un-scanned documents beneath this notice!**

**Do not remove this notice from this file!**

GPO Jacket No. 560-102  
Print Order 61540  
Rise Business Services, LLC  
Job=AZ15 5/13/2019



Box Number= AZ15040



Claim Begin-End: AMC423142-AMC423144

3 Transfers



AZ15040-19

AMC422569-AMC423150

AMC 423142

RECORDING REQUESTED BY:  
(Mail recording to;)  
Douglas Diamonds Corporation  
1300 N Charlotte Street  
Pottstown, PA 19464

FOR RECORDER'S USE

**UNPATENTED MINING CLAIM QUITCLAIM DEED**

**NOTICE IS HEREBY GIVEN** that Department of Land Transfer Information, Inc., a Wyoming Corporation whose current mailing address is 942 Calle Amanecer, Suite B, San Clemente, CA 92673 (collectively, "GRANTOR"), in consideration of money received and other good and valuable consideration, do hereby remise, release and forever quitclaim to;

Douglas Diamonds Corporation, whose mailing address is 1300 N Charlotte Street, Pottstown, PA 19464 (collectively, "Grantee"), all rights, title and interest of Grantor, in and to the following mining claim; The **Samoa East** lode mining claim, **AMC423144**.

BLM  
Date  
Stamp

The general course of this claim is East and West and it is situated in the Gila Salt River Meridian, Mohave County, Arizona.

This claim is 1,500 feet in length and 600 feet in width. This claim runs from the location monument on which this location notice is posted approximately 1,200 feet in an Easterly direction to the East end line and approximately 300 feet in a Southerly direction to the South end line.

This claim is marked by four (4) monuments, one at each corner of the claim. Additionally, there are two (2) end-line markers on each side of the center of the claim. All markers are 4" x 4" wooden posts that are buried 1.5' in the ground and protrude 4.5' above the ground embossed with the name of the claim and its location in relation to the claim.

The location monument on which this notice is posted is situated within Section 1, Township 23N, Range 18W, Gila Salt River Meridian, Mohave County Arizona and this claim encompasses portions of the following quarter section (s), Township (s) and Range (s); NE 1/4 of SE 1/4 Section 1, T23N, R18W, SE 1/4 of SE 1/4 Section 1, T23N, R18W, NW 1/4 of SW 1/4 Section 6, T23N, R17W and SW 1/4 of SW 1/4 Section 6, T23N, R17W, Gila Salt River Meridian, Mohave County Arizona.

The locality of this claim with reference to some natural object or permanent monument and additional information (if any) concerning its locality are as follows: SW corner of this claim is 920 Feet North and 870 Feet West of the SE corner of Section 1, T23N, R18W.

IN WITNESS WHEREOF, this Mining Claim Quitclaim Deed is executed on September 17, 2013:

**DEPARTMENT OF LAND TRANSFER INFORMATION, INC.**

  
Steven L. Cyros, President  
Authorized Officer for DEPARTMENT OF LAND TRANSFER INFORMATION, INC.

RECEIVED  
BLM AZ STATE OFFICE  
2013 SEP 24 P 3:36  
PHOENIX, ARIZONA

STATE OF CALIFORNIA  
COUNTY OF ORANGE, SS:

I, Brad Meindertma, a Notary Public in and for said County and State, hereby certify that Steven L. Cyros, personally appeared before me this day and acknowledged execution of the foregoing as his/her free and voluntary act and deed.

WITNESS my hand and notarial seal this 17 day of September, 2013.

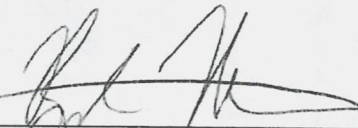
  
Notary Public

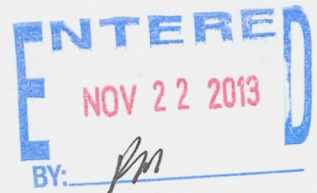





# DEPARTMENT OF LAND TRANSFER INFORMATION

PROTECTING AMERICA'S RESOURCES

STEVEN L. CYROS  
SUPERVISORY FIELD AGENT

942 CALLE AMANECER  
BLDG. B / MS 548  
SAN CLEMENTE, CA 92673  
TEL (949) 366-9484  
FAX (949) 366-9945  
SCYROS@DLTI.US.COM  
WWW.LANDTRANSFER.US.COM

September 20, 2013

Bureau of Land Management  
Arizona State Office  
One Central Avenue  
Suite 800  
Phoenix, AZ 85004-4427

RE: Mining Claim Change of Ownership/Quitclaim Deed to be processed

To Whom It May Concern:

Enclosed, please find a Mining Claim Change of Ownership Request in the form of Legal Quitclaim Deed (Notarized) to be processed.

Also attached you will find my check for payment in the amount of \$10.00 for the processing of this Quitclaim Deed. This has already been recorded at the Maricopa County Arizona Recorders Office as required.

You can either return this to me, and I will distribute it to the respective owner, or you can mail it to the individual whose name and address is indicated on the top of the document - whichever you prefer.

Should you need any additional information, please do not hesitate to call on me.

Warmest Regards,

Steven L. Cyros

RECEIVED  
BLM AZ STATE OFFICE  
2013 SEP 24 P 3:36  
PHOENIX, ARIZONA

RECEIVED  
CYROS L. CYROS  
2013



**Steven L. Cyros**

942 Calle Amanecer  
Bldg. B / MS 548  
San Clemente, CA 92673

SANTA ANA CA 9265

20 SEP 2013 PM 1 L



PHOENIX, ARIZONA

2013 SEP 24 P 3:36

RECEIVED  
BLM AZ STATE OFFICE

Bureau of Land Management  
Arizona State Office  
One North Central Ave., Suite 800  
Phoenix, AZ 85004-4427

85004442700



**Steven L. Cyros**

942 Calle Amanecer

Bldg. B / MS 548

San Clemente, CA 92673



**United States Department of the Interior**  
**Bureau of Land Management**  
 LANDS/RECREATION & PLANNING  
 ONE N CENTRAL AVE  
 PHOENIX, AZ 85004 -2203  
 Phone: 602-417-9200

Receipt

No: 2891403

<b>Transaction #:</b> 2977731	
<b>Date of Transaction:</b> 10/23/2013	
CUSTOMER:	
DEPARTMENT OF LAND TRANSFER INFORMATION 942 CALLE AMANECER STE B SAN CLEMENTE, CA 92673-6220 US	

LINE #	QTY	DESCRIPTION	REMARKS	UNIT PRICE	TOTAL
1	1.00	LOCATABLE MINERALS / MINING CLAIMS- NOT NEW-UNADJUD, ONE AUTH NO. ONLY / MINING CLAIM MONEY RECEIVED <b>CASES: AMC423144/\$10.00</b>	QCD - 1	- n/a -	10.00
<b>TOTAL:</b>					<b>\$10.00</b>

PAYMENT INFORMATION					
1	AMOUNT:	10.00	POSTMARKED:	N/A	
	TYPE:	CHECK	RECEIVED:	09/24/2013	
	CHECK NO:	4918			
	NAME:	DEPARTMENT OF LAND TRANSFER INFORMATION 942 CALLE AMANECER STE B SAN CLEMENTE CA 92673-6220 US			

REMARKS
TEMPORARY RECEIPT #184522

This receipt was generated by the automated BLM Collections and Billing System and is a paper representation of a portion of the official electronic record contained therein.

Amc 423142

RECORDING REQUESTED BY:

(Mail recording to;)

La Pilar LLC

5615 Potters Rd

Matthews, NC 28104-0508

FOR RECORDER'S USE

**UNPATENTED MINING CLAIM QUITCLAIM DEED**



**NOTICE IS HEREBY GIVEN** that Department of Land Transfer Information, Inc., a Wyoming Corporation whose current mailing address is 942 Calle Amanecer, Suite B, San Clemente, CA 92673 (collectively, "GRANTOR"), in consideration of money received and other good and valuable consideration, do hereby remise, release and forever quitclaim to;

La Pilar LLC, whose mailing address is 5615 Potters Rd., Matthews, NC 28104-0508 (collectively, "Grantee"), all rights, title and interest of Grantor, in and to the following mining claim; The **Butch** lode mining claim, **AMC423142**.

The general course of this claim is North and South and it is situated in the Gila Salt River Meridian, Mohave County, Arizona.

This claim is 1,500 feet in length and 600 feet in width. This claim runs from the location monument on which this location notice is posted approximately 1,200 feet in a Northerly direction to the North end line and approximately 300 feet in a Southerly direction to the South end line.

This claim is marked by four (4) monuments, one at each corner of the claim. Additionally, there are two (2) end-line markers on each side of the center of the claim. All markers are 4" x 4" wooden posts that are buried 1.5' in the ground and protrude 4.5' above the ground embossed with the name of the claim and its location in relation to the claim.

The location monument on which this notice is posted is situated within Section 1, Township 23N, Range 18W, Gila Salt River Meridian, Mohave County Arizona and this claim encompasses portions of the following quarter section (s), Township (s) and Range (s); NE 1/4 of SE 1/4 / L27, NW 1/4 of SE 1/4, L28, SE 1/4 of SE 1/4, L31 and SW 1/4 of SE 1/4 Section 1, T23N, R18W, Gila Salt River Meridian, Mohave County Arizona.

The locality of this claim with reference to some natural object or permanent monument and additional information (if any) concerning its locality are as follows: SE corner of this claim is 980 Feet West and 220 Feet North of the SE corner of Section 1, T23N, R18W.

IN WITNESS WHEREOF, this Mining Claim Quitclaim Deed is executed on August 15, 2013:

**DEPARTMENT OF LAND TRANSFER INFORMATION, INC.**

Steven L. Cyros, President  
Authorized Officer for DEPARTMENT OF LAND TRANSFER INFORMATION, INC.

STATE OF CALIFORNIA  
COUNTY OF ORANGE, SS:

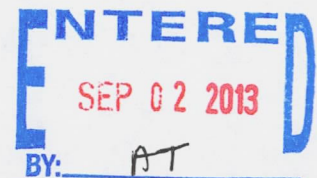

I, Brad Meindertson, a Notary Public in and for said County and State, hereby certify that Steven L. Cyros, personally appeared before me this day and acknowledged execution of the foregoing as his/her free and voluntary act and deed.

WITNESS my hand and notarial seal this 15 day of August, 2013

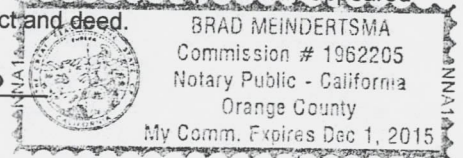



DEPARTMENT OF LAND TRANSFER INFORMATION  
PROTECTING AMERICA'S RESOURCES

STEVEN L. CYROS  
SUPERVISORY FIELD AGENT

942 CALLE AMANECEP  
BLDG. B / MS 548  
SAN CLEMENTE, CA 92673  
TEL (949) 366-9484  
FAX (949) 366-9945  
SCYROS@DLTI.US.COM  
WWW.LANDTRANSFER.US.COM

August 16, 2013

Bureau of Land Management  
Arizona State Office  
One Central Avenue  
Suite 800  
Phoenix, AZ 85004-4427

RECEIVED  
BLM AZ STATE OFFICE  
2013 AUG 19 PM 3:44  
PHOENIX, ARIZONA

RE: Mining Claim Change of Ownership/Quitclaim Deed to be processed

To Whom It May Concern:

Enclosed, please find a Mining Claim Change of Ownership Request in the form of Legal Quitclaim Deed (Notarized) to be processed.

Also attached you will find my check for payment in the amount of \$10.00 for the processing of this Quitclaim Deed. This has already been recorded at the Maricopa County Arizona Recorders Office as required.

You can either return this to me, and I will distribute it to the respective owner, or you can mail it to the individual whose name and address is indicated on the top of the document – whichever you prefer.

Should you need any additional information, please do not hesitate to call on me.

Warmest Regards,

Steven L. Cyros

INTERED  
SEP 05 2013  
BY



**Steven L. Cyros**

942 Calle Amanecer  
Bldg. B / MS 548  
San Clemente, CA 92673

SANTA ANA CA 926

15 AUG 2013 PM 2 L



PHOENIX ARIZONA

15 AUG 2013 PM 3:44

PHOENIX OFFICE

Bureau of Land Management  
Arizona State Office  
One North Central Ave., Suite 800  
Phoenix, AZ 85004-4427

85004442700



**Steven L. Cyros**

942 Calle Amanecer

Bldg. B / MS 548

San Clemente, CA 92673





**United States Department of the Interior**  
**Bureau of Land Management**  
 LANDS/RECREATION & PLANNING  
 ONE N CENTRAL AVE  
 PHOENIX, AZ 85004 -2203  
 Phone: 602-417-9200

Receipt

No: 2859985

<b>Transaction #:</b> 2945836	
<b>Date of Transaction:</b> 08/20/2013	
CUSTOMER:	
DEPARTMENT OF LAND TRANSFER INFORMATION 942 CALLE AMANECER STE B SAN CLEMENTE, CA 92673-6220 US	

LINE #	QTY	DESCRIPTION	REMARKS	UNIT PRICE	TOTAL
1	1.00	LOCATABLE MINERALS / MINING CLAIMS- NOT NEW-UNADJUD, ONE AUTH NO. ONLY / MINING CLAIM MONEY RECEIVED CASES: AMC423142/\$10.00	QCD - 1	- n/a -	10.00
<b>TOTAL:</b>					<b>\$10.00</b>

PAYMENT INFORMATION					
1	AMOUNT:	10.00	POSTMARKED:	08/15/2013	
	TYPE:	CHECK	RECEIVED:	08/19/2013	
	CHECK NO:	4885			
	NAME:	DEPARTMENT OF LAND TRANSFER INFORMATION 942 CALLE AMANECER STE B SAN CLEMENTE CA 92673-6220 US			

REMARKS

This receipt was generated by the automated BLM Collections and Billing System and is a paper representation of a portion of the official electronic record contained therein.

RECORDING REQUESTED BY:

(Mail recording to;)

LeRoy Ritter

50 Guinevere Ct.

Lafayette, IN 47905

AMC423142

FOR RECORDER'S USE

**UNPATENTED MINING CLAIM QUITCLAIM DEED**

**NOTICE IS HEREBY GIVEN** that Department of Land Transfer Information, Inc., a Wyoming Corporation whose current mailing address is 942 Calle Amanecer, Suite B, San Clemente, CA 92673 (collectively, "GRANTOR"), in consideration of money received and other good and valuable consideration, do hereby remise, release and forever quitclaim to;

LeRoy Ritter, whose mailing address is 50 Guinevere Ct., Lafayette, IN 47905 (collectively, "Grantee"), all rights, title and interest of Grantor, in and to the following mining claim; The **CLYDE** lode mining claim, **AMC423143**.

The general course of this claim is North and South and it is situated in the Gila Salt River Meridian, Mohave County, Arizona.

This claim is 1,500 feet in length and 600 feet in width. This claim runs from the location monument on which this location notice is posted approximately 1,200 feet in a Northerly direction to the North end line and approximately 300 feet in a Southerly direction to the South end line.

This claim is marked by four (4) monuments, one at each corner of the claim. Additionally, there are two (2) end-line markers on each side of the center of the claim. All markers are 4" x 4" wooden posts that are buried 1.5' in the ground and protrude 4.5' above the ground embossed with the name of the claim and its location in relation to the claim.

The location monument on which this notice is posted is situated within Section 1, Township 23N, Range 18W, Gila Salt River Meridian, Mohave County Arizona and this claim encompasses portions of the following quarter section (s), Township (s) and Range (s); SW 1/4 of NW 1/4 Section 1, NW 1/4 of SW 1/4 Section 1, T23N, R18W, SE 1/4 of NE 1/4 Section 2 and of NE 1/4 of SE 1/4 Section 2, T23N, R18W, Gila Salt River Meridian, Mohave County Arizona.

The locality of this claim with reference to some natural object or permanent monument and additional information (if any) concerning its locality are as follows: NW corner of this claim is 95 Feet West and 645 Feet South of the NW corner of SW 1/4 of NW 1/4 Section 1, T23N, R18W.

IN WITNESS WHEREOF, this Mining Claim Quitclaim Deed is executed on May 31, 2013:

**DEPARTMENT OF LAND TRANSFER INFORMATION, INC.**

Steven L. Cyros, President

Authorized Officer for DEPARTMENT OF LAND TRANSFER INFORMATION, INC.

RECEIVED	PHOENIX, ARIZONA
JUN -7 PM 2:50	
BLM	
Date	
Stamp	

ENTERED IN COMPUTER  
RE 7-30-13

# CALIFORNIA ALL-PURPOSE ACKNOWLEDGMENT

State of California  
County of Orange } ss.

On May 31, 2013 before me, Brad Meindertsma, Notary Public,  
Personally appeared Steven L. Cyros

who proved to me on the basis of satisfactory evidence to be the person (s) whose name(s) is/are subscribed to the within instrument and acknowledge to me that he/she/they executed the same in his/her/their authorized capacity(ies), and that by his/her/their signatures(s) on the instrument the person(s), or entity upon behalf of which the person(s) acted, executed the instrument.

I certify under the PENALTY OF PERJURY under the laws of the State of California that the foregoing paragraph is true and correct.

WITNESS my hand and official seal.

  
\_\_\_\_\_  
Signature



(seal)

## OPTIONAL INFORMATION

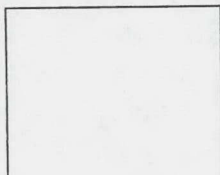
Date of Document	<u>May 31, 2013.</u>	Thumbprint of Signer
Type or Title of Document	<u>Quitclaim Deed</u>	
Number of Pages in Document	<u>1</u>	
Document in a Foreign Language	<u>NA</u>	

### Capacity of Signer:

Individual  
 Corporate Officer – Title(s): President  
 Partner -  Limited  General  
 Attorney In Fact  
 Trustee  
 Guardian or Conservator  
 Other: \_\_\_\_\_

Signer is Representing: Department of Land Transfer Information, Inc.

RECEIVED  
BLM AZ STATE OFFICE  
PHOENIX, ARIZONA  
2013 JUN -7 PM 2:51



# DEPARTMENT OF LAND TRANSFER INFORMATION

PROTECTING AMERICA'S RESOURCES

STEVEN L. CYROS  
SUPERVISORY FIELD AGENT

942 CALLE AMANEZER  
BLDG. B / MS 548  
SAN CLEMENTE, CA 92673  
TEL (949) 366-9484  
FAX (949) 366-9945  
SCYROS@DLTI.US.COM  
WWW.LANDTRANSFER.US.COM

June 5, 2013

Bureau of Land Management  
Arizona State Office  
One Central Avenue  
Suite 800  
Phoenix, AZ 85004-4427

RE: Mining Claim Change of Ownership/Quitclaim Deed to be processed

To Whom It May Concern:

Enclosed, please find a Mining Claim Change of Ownership Request in the form of Legal Quitclaim Deed (Notarized) to be processed.

Also attached you will find my check for payment in the amount of \$10.00 for the processing of this Quitclaim Deed. This has already been recorded at the Maricopa County Arizona Recorders Office as required.

You can either return this to me, and I will distribute it to the respective owner, or you can mail it to the individual whose name and address is indicated on the top of the document – whichever you prefer.

Should you need any additional information, please do not hesitate to call on me.

Warmest Regards,

Steven L. Cyros

RECEIVED  
BLM AZ STATE OFFICE  
2013 JUN -7 PM 2:50  
PHOENIX, ARIZONA

**United States Department of the Interior**  
**Bureau of Land Management**  
 LANDS/RECREATION & PLANNING  
 ONE N CENTRAL AVE  
 PHOENIX, AZ 85004 -2203  
 Phone: 602-417-9200

Receipt

No: 2809987

<b>Transaction #:</b> 2895070	
<b>Date of Transaction:</b> 06/10/2013	
CUSTOMER:	
	LEROY RITTER 50 GUINEVERE CT LAFAYETTE,IN 47905-9692 US

LINE #	QTY	DESCRIPTION	REMARKS	UNIT PRICE	TOTAL
1	1.00	LOCATABLE MINERALS / MINING CLAIMS- NOT NEW-UNADJUD,ONE AUTH NO. ONLY / MINING CLAIM MONEY RECEIVED CASES: AMC423143/\$10.00	QCD - 1	- n/a -	10.00
<b>TOTAL:</b>					<b>\$10.00</b>

FAILED

PAYMENT INFORMATION					
1	AMOUNT:	10.00	POSTMARKED:	06/05/2013	
	TYPE:	CHECK	RECEIVED:	06/07/2013	
	CHECK NO:	4834			
	NAME:	DEPARTMENT OF LAND TRANSFER INFORMATION 942 CALLE AMANECER BLDG B SAN CLEMENTE CA 92673 US			

REMARKS

This receipt was generated by the automated BLM Collections and Billing System and is a paper representation of a portion of the official electronic record contained therein.

**NOTICE!!**

**These documents have been scanned!**

**Do not place un-scanned documents beneath this notice!**

**Do not remove this notice from this file!**

GPO Jacket No. 560-102  
Print Order 61540  
Rise Business Services, LLC  
Job=AZ15 5/13/2019



Box Number= AZ15040



Claim Begin-End: AMC423142-AMC423144

4 Miscellaneous



AZ15040-19

AMC422569-AMC423150

**NO  
DOCUMENTS  
FOUND**

NO DOCUMENTS FOUND  
NO DOCUMENTS FOUND

**NOTICE!!**

**These documents have been scanned!**

**Do not place un-scanned documents beneath this notice!**

**Do not remove this notice from this file!**

GPO Jacket No. 560-102  
Print Order 61540  
Rise Business Services, LLC  
Job=AZ15 5/13/2019



Box Number= AZ15040



Claim Begin-End: AMC423142-AMC423144

5 Annual Filings



AZ15040-19 AMC422569-AMC423150



DEPARTMENT OF THE INTERIOR  
BUREAU OF LAND MANAGEMENT  
MINING CLAIMS

Run Date/Time: 8/20/2018

MC Maintenance Fees Paid Through the BLM Pay Portal  
(by Date Paid)

Page 230 Of 316

**CBS Receipt: 4236466**

Printed For Lead File # **AMC423142**

Agency Tracking ID: 1534343677

Assessment Year: 2019

Paid On: 8/15/2018

Number of BLM Serial Nr: 7

Total Amount Paid: \$1,240.00

Claim Name	BLM Serial No	Lead File No	Amount Paid
CLYDE	AMC423143	AMC423142	\$155.00
HIDDEN APPACHE	AMC423706	AMC423705	\$155.00
GV RENEGADE 1	AMC430042	AMC430042	\$310.00
GV RENEGADE 2	AMC430043	AMC430042	\$155.00
GV RENEGADE 3	AMC430044	AMC430042	\$155.00
GV RENEGADE 4	AMC430045	AMC430042	\$155.00
GV RENEGADE 5	AMC430046	AMC430042	\$155.00

**United States Department of the Interior  
Bureau of Land Management  
BUSINESS & SUPPORT SVCS DIV  
ONE N CENTRAL AVE SUITE 800  
PHOENIX, AZ 85004 -4427  
Phone: 602-417-9200**

Receipt

No: 4236466

<b>Transaction #:</b> 4351838	
<b>Date of Transaction:</b> 08/15/2018	
<b>CUSTOMER:</b>	
LEROY RITTER 3571 E CHAUNCEY CT LAFAYETTE, IN 47905 US	

LINE #	QTY	DESCRIPTION	REMARKS	UNIT PRICE	TOTAL
1	1.00	LOCATABLE MINERALS / MINING CLAIMS- NOT NEW-UNADJUD, ONE AUTH NO. ONLY / MINING CLAIM MONEY RECEIVED CASES: AMC423143/\$1240.00		- n/a -	1240.00
<b>TOTAL:</b>					<b>\$1,240.00</b>

PAYMENT INFORMATION				
NOTE: Items will appear on credit card statement as "BLM O Mining Claim".				
1	AMOUNT:	1240.00	POSTMARKED:	N/A
	TYPE:	CREDIT CARD	RECEIVED:	08/15/2018
	NAME:	LEROY RITTER 3571 E CHAUNCEY CT LAFAYETTE IN 47905 US		
	CARD NO:	XXXXXXXXXXXX2070	AUTH CODE:	04526B
	NAME ON CARD:	LEROY RITTER		
	SIGNATURE:			

REMARKS

This receipt was generated by the automated BLM Collections and Billing System and is a paper representation of a portion of the official electronic record contained therein.

Run Date: 09/05/17

Run Time: 02:33 PM

**DEPARTMENT OF THE INTERIOR  
BUREAU OF LAND MANAGEMENT  
MINING CLAIMS**

**MC Maintenance Fees Paid Through the BLM Pay Portal**

**CBS Receipt: 3963916**

Printed For Lead File # AMC423142

Agency Tracking ID: 1503953273

Number of BLM Serial Nr: 3

Assessment Year: 2018

Total Amount Paid: \$465.00

Paid On: 08/28/2017

Claim Name	BLM Serial No	Lead File No	Amount Paid
CLYDE	AMC423143	AMC423142	\$155.00
HIDDEN APPACHE	AMC423706	AMC423705	\$155.00
NEW RIVER	AMC438191	AMC438189	\$155.00

**United States Department of the Interior**  
**Bureau of Land Management**  
 BUSINESS & SUPPORT SVCS DIV  
 ONE N CENTRAL AVE SUITE 800  
 PHOENIX, AZ 85004 -4427  
 Phone: 602-417-9200

Receipt

No: 3963916

2

<b>Transaction #:</b> 4073789	
<b>Date of Transaction:</b> 08/28/2017	
CUSTOMER:	
LEROY RITTER 216 HERITAGE RD MONTICELLO, IN 47960 US	

LINE #	QTY	DESCRIPTION	REMARKS	UNIT PRICE	TOTAL
1	1.00	LOCATABLE MINERALS / MINING CLAIMS- NOT NEW-UNADJUD, ONE AUTH NO. ONLY / MINING CLAIM MONEY RECEIVED <b>CASES: AMC423143/\$465.00</b>		- n/a -	465.00
<b>TOTAL:</b>					<b>\$465.00</b>

PAYMENT INFORMATION			
NOTE: Items will appear on credit card statement as "BLM O Mining Claim".			
1	AMOUNT:	465.00	POSTMARKED: N/A
	TYPE:	CREDIT CARD	RECEIVED: 08/28/2017
	NAME:	LEROY RITTER 216 HERITAGE RD MONTICELLO IN 47960 US	
	CARD NO:	XXXXXXXXXXXX2070	AUTH CODE: 91788B
	NAME ON CARD:	LEROY RITTER	
	EXPIRES:	12/2020	
	SIGNATURE:		

REMARKS

This receipt was generated by the automated BLM Collections and Billing System and is a paper representation of a portion of the official electronic record contained therein.

Run Date: 09/14/16

Run Time: 01:48 PM

**DEPARTMENT OF THE INTERIOR  
BUREAU OF LAND MANAGEMENT  
MINING CLAIMS**

**MC Maintenance Fees Paid Through the BLM Pay Portal**

**CBS Receipt: 3649214**

Printed For Lead File # **AMC423142**

Agency Tracking ID: 1472658042

Number of BLM Serial Nr: 1

Assessment Year: 2017

Paid On: 08/31/2016

Total Amount Paid: \$155.00

Claim Name	BLM Serial No	Lead File No	Amount Paid
BUTCH	AMC423142	AMC423142	\$155.00

**United States Department of the Interior**  
**Bureau of Land Management**  
 BUSINESS & SUPPORT SVCS DIV  
 ONE N CENTRAL AVE SUITE 800  
 PHOENIX, AZ 85004 -4427  
 Phone: (602) 417-9200

Receipt

No: 3649214

<b>Transaction #:</b> 3753216	
<b>Date of Transaction:</b> 08/31/2016	
<b>CUSTOMER:</b>	
ANGELA JENNINGS 5615 POTTER RD MATTHEWS,NC 28104 US	

LINE #	QTY	DESCRIPTION	REMARKS	UNIT PRICE	TOTAL
1	1.00	LOCATABLE MINERALS / MINING CLAIMS- NOT NEW-UNADJUD,ONE AUTH NO. ONLY / MINING CLAIM MONEY RECEIVED <b>CASES: AMC423142/\$155.00</b>		- n/a -	155.00
<b>TOTAL:</b>					<b>\$155.00</b>

PAYMENT INFORMATION			
NOTE: Items will appear on credit card statement as "BLM O Mining Claim".			
1	AMOUNT:	155.00	POSTMARKED: N/A
	TYPE:	CREDIT CARD	RECEIVED: 08/31/2016
	NAME:	ANGELA JENNINGS 5615 POTTER RD MATTHEWS NC 28104 US	
	CARD NO:	XXXXXXXXXXXX1882	AUTH CODE: 03888G
	NAME ON CARD:	ANGELA JENNINGS	
	EXPIRES:	09/2018	
	SIGNATURE:		

REMARKS

This receipt was generated by the automated BLM Collections and Billing System and is a paper representation of a portion of the official electronic record contained therein.

Run Date: 09/08/16

Run Time: 12:27 PM

**DEPARTMENT OF THE INTERIOR  
BUREAU OF LAND MANAGEMENT  
MINING CLAIMS**

**MC Maintenance Fees Paid Through the BLM Pay Portal**

**CBS Receipt: 3636269**

Printed For Lead File # AMC423142

Agency Tracking ID: 1471689060

Assessment Year: 2017

Number of BLM Serial Nr: 8

Paid On: 08/20/2016

Total Amount Paid: \$1,395.00

Claim Name	BLM Serial No	Lead File No	Amount Paid
CLYDE	AMC423143	AMC423142	\$155.00
HIDDEN APPACHE	AMC423706	AMC423705	\$155.00
GV RENEGADE 1	AMC430042	AMC430042	\$310.00
GV RENEGADE 2	AMC430043	AMC430042	\$155.00
GV RENEGADE 3	AMC430044	AMC430042	\$155.00
GV RENEGADE 4	AMC430045	AMC430042	\$155.00
GV RENEGADE 5	AMC430046	AMC430042	\$155.00
NEW RIVER	AMC438191	AMC438189	\$155.00

**United States Department of the Interior  
Bureau of Land Management  
BUSINESS & SUPPORT SVCS DIV  
ONE N CENTRAL AVE SUITE 800  
PHOENIX, AZ 85004 -4427  
Phone: (602) 417-9200**

Receipt

No: 3636269

<b>Transaction #:</b> 3740122	
<b>Date of Transaction:</b> 08/20/2016	
CUSTOMER:	
	LEROY E RITTER 2136 N 900 E MONTICELLO, AZ 47960 US

LINE #	QTY	DESCRIPTION	REMARKS	UNIT PRICE	TOTAL
1	1.00	LOCATABLE MINERALS / MINING CLAIMS- NOT NEW-UNADJUD, ONE AUTH NO. ONLY / MINING CLAIM MONEY RECEIVED <b>CASES: AMC423143/\$1395.00</b>		- n/a -	1395.00
<b>TOTAL:</b>					<b>\$1,395.00</b>

PAYMENT INFORMATION			
NOTE: Items will appear on credit card statement as "BLM O Mining Claim".			
1	AMOUNT:	1395.00	POSTMARKED: N/A
	TYPE:	CREDIT CARD	RECEIVED: 08/20/2016
	NAME:	LEROY E RITTER 2136 N 900 E MONTICELLO AZ 47960 US	
	CARD NO:	XXXXXXXXXXXX2070	AUTH CODE: 01756B
	NAME ON CARD:	LEROY E RITTER	
	EXPIRES:	12/2020	
	SIGNATURE:		

REMARKS

This receipt was generated by the automated BLM Collections and Billing System and is a paper representation of a portion of the official electronic record contained therein.



Run Date: 09/08/15

Run Time: 09:20 AM

**DEPARTMENT OF THE INTERIOR  
BUREAU OF LAND MANAGEMENT  
MINING CLAIMS**

**MC Maintenance Fees Paid Through the BLM Pay Portal**

**CBS Receipt: 3377917**

Printed For Lead File # AMC423142

Agency Tracking ID: 1440615786

Assessment Year: 2016

Number of BLM Serial Nr: 1

Paid On: 08/26/2015

Total Amount Paid: \$155.00

Claim Name	BLM Serial No	Lead File No	Amount Paid
BUTCH	AMC423142	AMC423142	\$155.00

**United States Department of the Interior**  
**Bureau of Land Management**  
 BUSINESS & SUPPORT SVCS DIV  
 ONE N CENTRAL AVE SUITE 800  
 PHOENIX, AZ 85004 -4427  
 Phone: (602) 417-9200

Receipt

No: 3377917

<b>Transaction #:</b> 3476169	
<b>Date of Transaction:</b> 08/26/2015	
<b>CUSTOMER:</b>	
ANGELA JENNINGS 5615 POTTER RD MATTHEWS, NC 28104 US	

LINE #	QTY	DESCRIPTION	REMARKS	UNIT PRICE	TOTAL
1	1.00	LOCATABLE MINERALS / MINING CLAIMS- NOT NEW-UNADJUD, ONE AUTH NO. ONLY / MINING CLAIM MONEY RECEIVED CASES: AMC423142/\$155.00		- n/a -	155.00
<b>TOTAL:</b>					<b>\$155.00</b>

PAYMENT INFORMATION			
NOTE: Items will appear on credit card statement as "BLM O Mining Claim".			
1	AMOUNT:	155.00	POSTMARKED: N/A
	TYPE:	CREDIT CARD	RECEIVED: 08/26/2015
	NAME:	ANGELA JENNINGS 5615 POTTER RD MATTHEWS NC 28104 US	
	CARD NO:	XXXXXXXXXXXX1882	AUTH CODE: 05473G
	NAME ON CARD:	ANGELA JENNINGS	
	EXPIRES:	09/2018	
	SIGNATURE:		

REMARKS

This receipt was generated by the automated BLM Collections and Billing System and is a paper representation of a portion of the official electronic record contained therein.

UNITED STATES  
DEPARTMENT OF THE INTERIOR  
BUREAU OF LAND MANAGEMENT

423142

423705

**CREDIT CARD PAYMENT**  
**For Mining Claim Maintenance Fee**

THIS IS A CHANGE OF ADDRESS

TELEPHONE SUBMISSION - ACCURACY OF THE BELOW INFORMATION IS THE RESPONSIBILITY OF THE CLAIMANT/OWNER

NAME Leroy E Ritter  
ADDRESS 50 Guenivere Court  
CITY Lafayette STATE IN ZIP 47905  
PHONE # 574 - 595 0912

SEND RECEIPT TO  Above address  
 Other (Include Name and Mailing Address);

\_\_\_\_\_  
\_\_\_\_\_  
\_\_\_\_\_

AMC NUMBER

AMC 423143  
ANC 423706

CLAIM/SITE NAME

\_\_\_\_\_  
\_\_\_\_\_

2 # of Claim/Site  
x 155.00 Each  
\$ 31000 Total Charged \_\_\_\_\_ (INITIALS)

RECEIPT # 3358731

DATE STAMP

ENTERED  
AUG 05 2015  
BY: RAR

RECEIVED  
BLM AZ STATE OFFICE  
2015 AUG - 4 P 2: 56  
PHOENIX, ARIZONA

\*\*\*\* FOR OFFICIAL USE ONLY \*\*\*\*  
DATE 8/4/15 INITIALS PER VERIFIED \_\_\_\_\_

**United States Department of the Interior**  
**Bureau of Land Management**  
 LANDS/RECREATION & PLANNING  
 ONE N CENTRAL AVE  
 PHOENIX, AZ 85004 -2203  
 Phone: 602-417-9200

Receipt

No: 3358734

Transaction #: 3456700	
Date of Transaction: 08/04/2015	
CUSTOMER:	
LEROY RITTER 50 GUINEVERE CT LAFAYETTE, IN 47905-9692 US	

LINE #	QTY	DESCRIPTION	REMARKS	UNIT PRICE	TOTAL
1	1.00	LOCATABLE MINERALS / MINING CLAIMS-NOT NEW-UNADJUD.ONE AUTH NO. ONLY / MINING CLAIM MONEY RECEIVED CASES: AMC423143/\$310.00	2016 MAIN/2	- n/a -	310.00
<b>TOTAL:</b>					<b>\$310.00</b>

PAYMENT INFORMATION			
NOTE: Items will appear on credit card statement as "Bureau of Land Mgmt CO".			
1	AMOUNT:	310.00	POSTMARKED: N/A
	TYPE:	CREDIT CARD	RECEIVED: 08/04/2015
	NAME:	RITTER, LEROY 50 GUINEVERE CT LAFAYETTE IN 47905-9692 US	
	CARD NO:	XXXXXXXXXXXX6050	AUTH CODE: 165528
	NAME ON CARD:	LEROY E RITTER	
	EXPIRES:	08/2017	
	SIGNATURE:		

REMARKS

This receipt was generated by the automated BLM Collections and Billing System and is a paper representation of a portion of the official electronic record contained therein.

ENTERED  
 AUG 05 2015  
 BY: RAM

UNITED STATES  
DEPARTMENT OF THE INTERIOR  
BUREAU OF LAND MANAGEMENT

542

Amc 413935  
Amc 423142

MAINTENANCE FEE WAIVER CERTIFICATION

FORM APPROVED  
OMB NO. 1004-0114

Expires: October 31, 2016

Amc 410995

SEE INSTRUCTIONS ON PAGE 2

- This small miner waiver is filed for the assessment year beginning on September 1, 2014 and ending on September 1, 2015.
- The undersigned and all related parties owned ten or fewer mining claims, mill, or tunnel sites located and maintained on Federal lands in the United States of America on September 1, 2014.
- The undersigned have performed the assessment work required by law for each mining claim listed prior to filing this waiver and understand that by filing this form, the undersigned must file an affidavit of assessment work with the Bureau of Land Management (BLM) by the December 30th following the filing of this waiver.
- The undersigned understand that if the assessment work obligation has not yet come due under 30 U.S.C. 28 (for those claims in their first assessment year only), a notice of intent to hold reciting this condition must be recorded by the December 30th following the filing of this waiver.
- The undersigned understand that mill and tunnel sites may also be listed on this waiver and be waived from payment of the maintenance fee, and that a notice of intent to hold for these sites is required to be filed with the BLM by the December 30th following the filing of this waiver.
- The undersigned understand and acknowledge that pursuant to 43 U.S.C. 1212 and 18 U.S.C. 1001, the filing or recording of a false, fictitious, or fraudulent document with the BLM may result in a fine of up to \$250,000, a prison term not to exceed five years, or both.
- The mining claims, mill or tunnel sites for which this waiver from payment of the maintenance fees is requested are:

CLAIM OR SITE NAME	BLM RECORDATION SERIAL NUMBER
1. Samoa	✓ AMC413966
2. Samoa East	AMC423144
3.	
4.	
5.	
6.	
7.	
8.	
9.	
10.	

RECEIVED  
BLM AZ STATE OFFICE  
2014 AUG 28 P 1:17  
PHOENIX, ARIZONA

The owner(s) (claimants) of the above mining claims and sites are:

Douglas Diamonds Corp  
(Owner's Name - Please Print)  
 1300 N Charlotte St.  
(Owner's Mailing Address)

Scott D. By  
(Owner's Signature) CEO  
 Pottstown PA 19464  
(City) (State) (Zip Code)

\_\_\_\_\_  
(Owner's Name - Please Print)

\_\_\_\_\_  
(Owner's Signature)

\_\_\_\_\_  
(Owner's Mailing Address)

\_\_\_\_\_  
(City) (State) (Zip Code)

\_\_\_\_\_  
(Owner's Name - Please Print)

\_\_\_\_\_  
(Owner's Signature)

\_\_\_\_\_  
(Owner's Mailing Address)

\_\_\_\_\_  
(City) (State) (Zip Code)

\_\_\_\_\_  
(Owner's Name - Please Print)

\_\_\_\_\_  
(Owner's Signature)

\_\_\_\_\_  
(Owner's Mailing Address)

\_\_\_\_\_  
(City) (State) (Zip Code)

(Continued on page 2)

ENTERED  
SEP 18 2014  
BY: AT

UNITED STATES 1584  
DEPARTMENT OF THE INTERIOR  
BUREAU OF LAND MANAGEMENT

**MAINTENANCE FEE WAIVER CERTIFICATION**

FORM APPROVED  
OMB NO. 1004-0114  
Expires: October 31, 2016

SEE INSTRUCTIONS ON PAGE 2

1. This small miner waiver is filed for the assessment year beginning on September 1, 2014 and ending on September 1, 2015.
2. The undersigned and all related parties owned ten or fewer mining claims, mill, or tunnel sites located and maintained on Federal lands in the United States of America on September 1, 2014.
3. The undersigned have performed the assessment work required by law for each mining claim listed prior to filing this waiver and understand that by filing this form, the undersigned must file an affidavit of assessment work with the Bureau of Land Management (BLM) by the December 30th following the filing of this waiver.
4. The undersigned understand that if the assessment work obligation has not yet come due under 30 U.S.C. 28 (for those claims in their first assessment year only), a notice of intent to hold reciting this condition must be recorded by the December 30th following the filing of this waiver.
5. The undersigned understand that mill and tunnel sites may also be listed on this waiver and be waived from payment of the maintenance fee, and that a notice of intent to hold for these sites is required to be filed with the BLM by the December 30th following the filing of this waiver.
6. The undersigned understand and acknowledge that pursuant to 43 U.S.C. 1212 and 18 U.S.C. 1001, the filing or recording of a false, fictitious, or fraudulent document with the BLM may result in a fine of up to \$250,000, a prison term not to exceed five years, or both.
7. The mining claims, mill or tunnel sites for which this waiver from payment of the maintenance fees is requested are:

CLAIM OR SITE NAME	BLM RECORDATION SERIAL NUMBER
1. <u>Sunflower</u>	<u>AMC410995</u>
2. <u>Sycamore</u>	<u>AMC410996</u>
3.	
4.	
5.	
6.	
7.	
8.	
9.	
10.	

RECEIVED  
BLM AZ STATE OFFICE  
2014 AUG 28 PM 1:17  
PHOENIX, ARIZONA

The owner(s) (claimants) of the above mining claims and sites are:

Scott Boyer  
(Owner's Name - Please Print)  
534 Centre Ave.  
(Owner's Mailing Address)

Scott D. Boyer  
(Owner's Signature)  
Reading PA 19601  
(City) (State) (Zip Code)

(Owner's Name - Please Print)

(Owner's Signature)

(Owner's Mailing Address)

(City) (State) (Zip Code)

(Owner's Name - Please Print)

(Owner's Signature)

(Owner's Mailing Address)

(City) (State) (Zip Code)

(Owner's Name - Please Print)

(Owner's Signature)

(Owner's Mailing Address)

(City) (State) (Zip Code)

This packaging is the property of the U.S. Postal Service and is provided solely for use in sending Priority Mail Express<sup>™</sup> shipments. Please may be a violation of federal law. This packaging is not for resale. EPI3F © U.S. Postal Service July 2013. All rights reserved.

**UNITED STATES POSTAL SERVICE** **Click-N-Ship<sup>®</sup>**

**E** ups.com 9470 1036 9930 0006 4844 65 0181 1000 0006 5004  
 \$18.11 US POSTAGE  
 Flat Rate Env

08/27/14 Commercial Base Pricing  
 Mailed from 19601 062S0000001307

**PRIORITY MAIL EXPRESS 1-DAY<sup>™</sup>**

SCOTT D BOYER  
 DOUGLAS D.  
 634 CENTRE AVE  
 READING PA 19601-2899

Scheduled Delivery Date: 08/28/14  
**0007**

**C041**

WAIVER OF SIGNATURE  
 SCHEDULED DELIVERY 3:00 PM

SHIP TO:  
 BLM STATE OFFICE  
 1 N CENTRAL AVE  
 STE 800  
 PHOENIX AZ 85004-4427

**USPS TRACKING #**

9470 1036 9930 0006 4844 65

**UNITED STATES POSTAL SERVICE**



**VISIT US AT USPS.COM<sup>®</sup>**  
ORDER FREE SUPPLIES ONLINE

+ Money Back Guarantee for U.S. destinations only.

**PRIORITY MAIL<sup>™</sup> EXPRESS<sup>™</sup>**

RECEIVED BLM AZ STATE OFFICE  
 2014 AUG 28 P 11  
 PHOENIX, ARIZONA  
 OUR FASTEST SERVICE IN THE U.S.

WHEN USED INTERNATIONALLY,  
 A CUSTOMS DECLARATION  
 LABEL MAY BE REQUIRED.



EPI3F July 2013 OD: 12.5 x 9.5



PS10001000006

423142

UNITED STATES  
DEPARTMENT OF THE INTERIOR  
BUREAU OF LAND MANAGEMENT  
MAINTENANCE FEE PAYMENT FORM FOR  
LODE CLAIMS, MILL SITES, AND TUNNEL SITES

Remitter Name: La Pillar LLC  
Mailing Address: 5615 Potter Rd.  
City, State, Zip: Matthews, NC 28104

Check here if this is a change of address.

FOR COUNTY RECORDER'S USE

No. of claims/sites 1  
x \$140 per claim/site  
Total due BLM \$ 155-

- The maintenance fee may be paid by cash, check, money order, Bureau of Land Management (BLM) Declining Deposit Account, or credit card (VISA, American Express, Discover, or MasterCard). Payments must be remitted to the BLM State Office where your claim or site is recorded and received on or before September 1. If the payment is mailed, the envelope must be postmarked by a bona fide delivery service on or before September 1 and received at the proper BLM State Office within 15 calendar days after the due date. Payments may also be made by telephone using a credit card. A complete listing of BLM State Offices with their addresses and phone numbers can be found at <http://www.blm.gov>.
- The maintenance fee for the following claim(s)/site(s) applies to the assessment year 2015

CLAIM/SITE NAME	BLM SERIAL NO.
BUTCH	AMC 423142

ENTERED  
SEP 02 2014  
BY: pa

RECEIVED  
BLM STATE OFFICE  
PHOENIX, ARIZONA  
2014 AUG 27 P 2:20

Use a separate sheet for additional claim/site names, serial numbers, and claimant names and addresses.

RECEIPT # 3115327



CHARLOTTE NC 282

25 AUG 2014 PM 4 L



RECEIVED  
BLM AZ STATE OFFICE

2014 AUG 27 P 2: 20

PHOENIX, ARIZONA

For your area, visit [www.gosatguard.com](http://www.gosatguard.com)  
(S) or 800-565-0559 (Canada).



85004442700



**United States Department of the Interior**  
**Bureau of Land Management**  
 LANDS/RECREATION & PLANNING  
 ONE N CENTRAL AVE  
 PHOENIX, AZ 85004 -2203  
 Phone: 602-417-9200

Receipt

No: 3115327

<b>Transaction #:</b> 3207066		<b>ENTERED INTO COMPUTER</b>
<b>Date of Transaction:</b> 08/28/2014		
<b>CUSTOMER:</b> SEP - 2 2014 <i>RF</i>		
LA PILLAR LLC 5615 POTTERS RD MATTHEWS, NC 28104-0508 US		

LINE #	QTY	DESCRIPTION	REMARKS	UNIT PRICE	TOTAL
1	1.00	LOCATABLE MINERALS / MINING CLAIMS- NOT NEW-UNADJUD, ONE AUTH NO. ONLY / MINING CLAIM MONEY RECEIVED <b>CASES: AMC423142/\$155.00</b>	MAINT FEE PYMNT (1) 2015	- n/a -	155.00
<b>TOTAL:</b>					<b>\$155.00</b>

PAYMENT INFORMATION						
1	AMOUNT:	155.00	POSTMARKED:	08/25/2014		
	TYPE:	CHECK	RECEIVED:	08/27/2014		
	CHECK NO:	22316				
	NAME:	R D HARRELL COMPANY 5615 POTTERS RD MATTHEWS NC 28104-0508 US				

REMARKS

This receipt was generated by the automated BLM Collections and Billing System and is a paper representation of a portion of the official electronic record contained therein.

UNITED STATES  
DEPARTMENT OF THE INTERIOR  
BUREAU OF LAND MANAGEMENT  
**MAINTENANCE FEE PAYMENT FORM  
FOR PLACER MINING CLAIMS**

AMC423142  
423705

Remitter Name: Ritter LeRoy  
Mailing Address: 50 Guinevere Court  
City, State, Zip: Lafayette IN 47905

Check here if this is a change of address.

**FOR COUNTY RECORDER'S USE**

No. of claims 2  
Total due BLM \$ 310.00

*Rec. 3104546 8/5*

- The maintenance fee may be paid by cash, check, money order, Bureau of Land Management (BLM) Declining Deposit Account, or credit card (VISA, American Express, Discover, or MasterCard). Payments must be remitted to the BLM State Office where your claim or site is recorded and received on or before September 1. If the payment is mailed, the envelope must be postmarked by a bona fide delivery service on or before September 1 and received at the proper BLM State Office within 15 calendar days after the due date. Payments may also be made by telephone using a credit card. A complete listing of BLM State Offices with their addresses and phone numbers can be found at <http://www.blm.gov>.
- The maintenance fee for the following claim(s) applies to the assessment year 2014.

CLAIM NAME	BLM SERIAL NO.	ACRES IN CLAIM	PAYMENT DUE TO THE BLM (See Instructions on Page 2)
Clyde	AMC423143	20.666	155.00
Hidden Apache	AMC423706	20.666	155.00

RECEIVED  
BLM AZ STATE OFFICE  
2014 AUG 18 A 10:45  
PHOENIX, ARIZONA

Use a separate sheet for additional claim names, serial numbers, and claimant names and addresses.

(Continued on page 2)

**ENTERED**  
AUG 19 2014  
BY: RAM

**United States Department of the Interior**  
**Bureau of Land Management**  
 LANDS/RECREATION & PLANNING  
 ONE N CENTRAL AVE  
 PHOENIX, AZ 85004 -2203  
 Phone: 602-417-9200

ENTERED  
 AUG 19 2014  
 BY: *Ritter*

Receipt

No: 3104546

<b>Transaction #:</b> 3196145	
<b>Date of Transaction:</b> 08/18/2014	
CUSTOMER:	
RITTER LEROY 50 GUINEVERE CT LAFAYETTE, IN 47905-9692 US	

LINE #	QTY	DESCRIPTION	REMARKS	UNIT PRICE	TOTAL
1	1.00	LOCATABLE MINERALS / MINING CLAIMS- NOT NEW-UNADJUD, ONE AUTH NO. ONLY / MINING CLAIM MONEY RECEIVED <b>CASES:</b> AMC423143/\$310.00	2015 MAINT (2)	- n/a -	310.00
<b>TOTAL:</b>					<b>\$310.00</b>

PAYMENT INFORMATION			
NOTE: Items will appear on credit card statement as "Bureau of Land Mgmt CO".			
1	AMOUNT:	310.00	POSTMARKED: N/A
	TYPE:	CREDIT CARD	RECEIVED: 08/18/2014
	NAME:	LEROY, RITTER 50 GUINEVERE CT LAFAYETTE IN 47905-9692 US	
	CARD NO:	XXXXXXXXXXXX5604	AUTH CODE: 153106
	NAME ON CARD:	RITTER E LEROY	
	EXPIRES:	09/2015	
	SIGNATURE:		

REMARKS

This receipt was generated by the automated BLM Collections and Billing System and is a paper representation of a portion of the official electronic record contained therein.

423142  
~~423144~~  
 424557

**MAINTENANCE FEE PAYMENT**

Claimant Name: DEPARTMENT OF LAND TRANSFER INFORMATION, INC.  
 Address: 942 CALLE AMANECOA, STE B  
 City: SAN CLEMENTE State: CA Zip: 92673  
 Telephone: 949-366-9424  
 E-mail address: SCYROS@COX.NET  
 Signature: [Signature]

RECEIVED  
 BLM AZ STATE OFFICE  
 2013 AUG 30 P 2:51  
 PHOENIX, ARIZONA  
 BLM Date Stamp

Check here if this is a change of address.

LINE NO.	AMC NUMBER	CLAIM/SITE NAME	COUNTY RECORDER DATA (If available)	TWP	RNG	SEC
1	AMC424559	MISTAKE MINE	NOT AVAIL	8N	5W	12
2	AMC423144	SAMOA EAST	NOT AVAIL	23N	18W	1
3	AMC424557	CAMP MINE	NOT AVAIL	7N	3W	13
4						
5						
6						
7						
8						
9						
10						

List additional claims on Form MCF114.

Bureau of Land Management  
 Arizona State Office  
[www.blm.gov/az/](http://www.blm.gov/az/)

No. of Claims: 3 x \$140 = 420  
 Check No: 4904 Init. [Signature]  
 Receipt No.: 2871074  
 For BLM Use Only

Form: MCF112  
 Revised July 2009

This form is available from the Arizona Department of Mines and Mineral Resources and may be reproduced.

ENTERED  
 SEP - 9 2013  
 BY: [Signature]

United States Department of the Interior

Bureau of Land Management

LANDS/RECREATION & PLANNING

ONE N CENTRAL AVE

PHOENIX, AZ 85004 -2203

Phone: 602-417-9200

Receipt

No:

2871074

<b>Transaction #:</b> 2957083	
<b>Date of Transaction:</b> 08/30/2013	
CUSTOMER:	
DEPARTMENT OF LAND TRANSFER INFORMATION 942 CALLE AMANECER STE B SAN CLEMENTE, CA 92673-6220 US	

LINE #	QTY	DESCRIPTION	REMARKS	UNIT PRICE	TOTAL
1	1.00	LOCATABLE MINERALS / MINING CLAIMS-NOT NEW-UNADJUD, ONE AUTH NO. ONLY / MINING CLAIM MONEY RECEIVED CASES: AMC424559/\$420.00	MAINT 2014/3	- n/a -	420.00
<b>TOTAL:</b>					<b>\$420.00</b>

PAYMENT INFORMATION			
1	AMOUNT:	420.00	POSTMARKED: 08/30/2013
	TYPE:	CHECK	RECEIVED: 08/30/2013
	CHECK NO:	4906	
	NAME:	DEPARTMENT OF LAND TRANSFER INFORMATION 942 CALLE AMANECER STE B SAN CLEMENTE CA 92673-6220 US	

REMARKS

This receipt was generated by the automated BLM Collections and Billing System and is a paper representation of a portion of the official electronic record contained therein.

UNITED STATES  
DEPARTMENT OF THE INTERIOR  
BUREAU OF LAND MANAGEMENT  
MAINTENANCE FEE PAYMENT FORM FOR  
LODE CLAIMS, MILL SITES, AND TUNNEL SITES

AMC 423142  
AMC 423705

RECEIVED  
BLM  
AZ STATE OFFICE  
2013 AUG 22 P 3:06  
PHOENIX, ARIZONA

Remitter Name: LEROY RITTER  
Mailing Address: 50 GUINEVERE CT.  
City, State, Zip: LAFAYETTE, IN 47905

Check here if this is a change of address.

FOR COUNTY RECORDER'S USE

No. of claims/sites 2  
x \$140 per claim/site  
Total due BLM \$ 280.00

- The maintenance fee may be paid by cash, check, money order, Bureau of Land Management (BLM) Declining Deposit Account, or credit card (VISA, American Express, Discover, or MasterCard). Payments must be remitted to the BLM State Office where your claim or site is recorded and received on or before September 1. If the payment is mailed, the envelope must be postmarked by a bona fide delivery service on or before September 1 and received at the proper BLM State Office within 15 calendar days after the due date. Payments may also be made by telephone using a credit card. A complete listing of BLM State Offices with their addresses and phone numbers can be found at <http://www.blm.gov>.
- The maintenance fee for the following claim(s)/site(s) applies to the assessment year 2014.

CLAIM/SITE NAME	BLM SERIAL NO.
CLYDE	AMC 423143
HIDDEN APACHE	AMC 423706

Use a separate sheet for additional claim/site names, serial numbers, and claimant names and addresses.

(Continued on page 2)

ENTERED  
AUG 28 2013  
BY: TS

Receipt # 2862884  
A.H.

LeRoy Ritter  
50 Guineverect.  
Lafayette IN 47905

INDIANAPOLIS IN 460

19 AUG 2013 PM 3 L



Bureau of Land Management  
State Office  
One North Central Avenue, Suite 800  
Phoenix, Arizona 85004-4427

RECEIVED  
BLM AZ STATE OFFICE  
2013 AUG 22 P 3:06  
PHOENIX, ARIZONA

85004442700

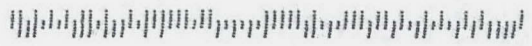



**United States Department of the Interior**  
**Bureau of Land Management**  
 LANDS/RECREATION & PLANNING  
 ONE N CENTRAL AVE  
 PHOENIX, AZ 85004 -2203  
 Phone: 602-417-9200

Receipt

No: 2862884

<b>Transaction #:</b> 2948776	
<b>Date of Transaction:</b> 08/23/2013	
<b>CUSTOMER:</b>	
LEROY RITTER 50 GUINEVERE CT LAFAYETTE,IN 47905-9692 US	

LINE #	QTY	DESCRIPTION	REMARKS	UNIT PRICE	TOTAL
1	1.00	LOCATABLE MINERALS / MINING CLAIMS- NOT NEW-UNADJUD,ONE AUTH NO. ONLY / MINING CLAIM MONEY RECEIVED CASES: AMC423143/\$280.00	MAINT FEE PYMNT (2) 2014	- n/a -	280.00
<b>TOTAL:</b>					<b>\$280.00</b>

PAYMENT INFORMATION					
1	AMOUNT:	280.00	POSTMARKED:	08/19/2013	
	TYPE:	CHECK	RECEIVED:	08/22/2013	
	CHECK NO:	1573			
	NAME:	SUPERIOR JANITORIAL 9713 E 700 N IDAVILLE IN 47950 US			

REMARKS

This receipt was generated by the automated BLM Collections and Billing System and is a paper representation of a portion of the official electronic record contained therein.

AMC 423142

UNITED STATES  
DEPARTMENT OF THE INTERIOR  
BUREAU OF LAND MANAGEMENT  
MAINTENANCE FEE PAYMENT FORM FOR  
LODE CLAIMS, MILL SITES, AND TUNNEL SITES

Remitter Name: LaPILLAR LLC  
Mailing Address: 5615 POTTER RD.  
City, State, Zip: MATTHEWS, NC 28104

Check here if this is a change of address.

FOR COUNTY RECORDER'S USE

No. of claims/sites 1  
x \$140 per claim/site  
Total due BLM \$ 140<sup>00</sup>

- The maintenance fee may be paid by cash, check, money order, Bureau of Land Management (BLM) Declining Deposit Account, or credit card (VISA, American Express, Discover, or MasterCard). Payments must be remitted to the BLM State Office where your claim or site is recorded and received on or before September 1. If the payment is mailed, the envelope must be postmarked by a bona fide delivery service on or before September 1 and received at the proper BLM State Office within 15 calendar days after the due date. Payments may also be made by telephone using a credit card. A complete listing of BLM State Offices with their addresses and phone numbers can be found at <http://www.blm.gov>.
- The maintenance fee for the following claim(s)/site(s) applies to the assessment year 2014.

CLAIM/SITE NAME	BLM SERIAL NO.
BUTCH	AMC 423142

RECEIVED  
 BLM AZ STATE OFFICE  
 2013 AUG -9 PM 3: 34  
 PHOENIX, ARIZONA

Use a separate sheet for additional claim/site names, serial numbers, and claimant names and addresses.

(Continued on page 2)

ENTERED INTO COMPUTER  
AUG 19 2013 TS

NO. OF CLAIMS 1  
AMOUNT \$140.00  
RECEIPT NO. 2850735  
INIT. [Signature]  
\*\* BLM-ASO\*\*

**United States Department of the Interior**  
**Bureau of Land Management**  
 LANDS/RECREATION & PLANNING  
 ONE N CENTRAL AVE  
 PHOENIX, AZ 85004 -2203  
 Phone: 602-417-9200

Receipt

No: 2852735

<b>Transaction #:</b> 2938496	
<b>Date of Transaction:</b> 08/12/2013	
CUSTOMER:	
R.D. HARRELL COMPANY 5615 POTTERS RD MATTHEWS,NC 28104-0508 US	

LINE #	QTY	DESCRIPTION	REMARKS	UNIT PRICE	TOTAL
1	1.00	LOCATABLE MINERALS / MINING CLAIMS- NOT NEW-UNADJUD,ONE AUTH NO. ONLY / MINING CLAIM MONEY RECEIVED CASES: AMC423142/\$140.00	MAINT FEE PYMNT (1) 2014	- n/a -	140.00
<b>TOTAL:</b>					<b>\$140.00</b>

PAYMENT INFORMATION					
1	AMOUNT:	140.00	POSTMARKED:	08/06/2013	
	TYPE:	CHECK	RECEIVED:	08/09/2013	
	CHECK NO:	21783			
	NAME:	RD HARRELL COMPANY 5615 POTTERS RD MATTHEWS NC 28104-0508 US			

REMARKS

This receipt was generated by the automated BLM Collections and Billing System and is a paper representation of a portion of the official electronic record contained therein.

**NOTICE!!**

**These documents have been scanned!**

**Do not place un-scanned documents beneath this notice!**

**Do not remove this notice from this file!**

GPO Jacket No. 560-102  
Print Order 61540  
Rise Business Services, LLC  
Job=AZ15 5/13/2019



Box Number= AZ15040



Claim Begin-End: AMC423142-AMC423144

6 Location Notices-Amendments and Supporting Documents



AZ15040-19

AMC422569-AMC423150

DEPARTMENT OF THE INTERIOR  
BUREAU OF LAND MANAGEMENT  
MINING CLAIMS

413935

423142

MC Customer Information - With Serial No. and Claim Name  
ACTIVE CLAIMS

Admin State: AZ

Geo State: AZ

DOUGLAS DIAMONDS CORP  
1300 N CHARLOTTE ST  
POTTSTOWN, PA 19464-2351

FOLDERS (PB)  
K

CUSTOMER ID: 2327342

Serial No.                      Claim Name/Number

AMC413966

SAMOA

AMC423144

SAMOA EAST

Number of ACTIVE cases: 2

Lead Serial No.

AMC413935

AMC423142

Disposition

ACTIVE

ACTIVE

**UNITED STATES  
DEPARTMENT OF THE INTERIOR**

Bureau of Land Management  
Arizona State Office  
1 North Central Avenue, Suite 800  
Phoenix, Arizona 85004

Official Business  
Penalty for Private Use, \$300

neopost  
01/22/2015  
01/22/2015

FIRST-CLASS MAIL  
\$00.48<sup>00</sup>  
US OFFICIAL MAIL  
\$300 Penalty  
For Private Use  
ZIP 85004  
041L11101433

**DOUGLAS DIAMONDS CORP**

**1300 N**

**POTTS**

NIXIE 176 DE 1009 0001/29/15

RETURN TO SENDER  
NOT DELIVERABLE AS ADDRESSED  
UNABLE TO FORWARD

BC: 85004442700 \*0614-02660-22-46

85004@4427  
19404#2351 C

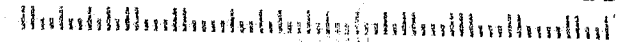

**DEPARTMENT OF THE INTERIOR  
BUREAU OF LAND MANAGEMENT**

**MINING CLAIMS**

**(LIVE) Serial Register Page**

Run Date/Time: 04/23/2015 08:29 AM

Page 1 of 1

01 05-10-1872;017STAT0091;30USC26,28,34

**Total Acres**

**Serial Number**

Case Type 384101: LODE CLAIM

**20.660**

**AMC423144**

Claim Name: SAMOA EAST

**Lead File Number**

Commodity :

**AMC423142**

Case Disposition: CLOSED

Required Maintenance Fee: \$155.00

Name & Address	Int Rel
DOUGLAS DIAMONDS CORP 1300 N CHARLOTTE ST POTTSTOWN, PA 19464-2351	CLAIMANT

Mer Twp	Rng	Sec	Quadrant	District/Field Office	County	
14	0230N	0170W	006	SW	KINGMAN FO	MOHAVE
14	0230N	0180W	001	SE	KINGMAN FO	MOHAVE

Act Date	Code	Action	Action Remarks	Receipt Number
04/28/2013	403	LOCATION DATE		
05/17/2013	395	RECORDATION NOTICE RECD	1	2796637
08/28/2014	483	SMALL MINER CERT FILED	2015	
08/30/2013	682	MAINTENANCE FEE/\$140	2014;\$140	2871074
05/17/2013	484	LOCATION YEAR / MAINTENANCE	2013;\$140	2796637
02/26/2015	393	DECISION/NOTICE ISSUED	NO 2014 NOI	
12/30/2014	631	CLAIM ABANDONED/FORFEITED	NO 2014 NOI	
09/17/2013	396	TRF OF INTEREST FILED	DEPARTMENT OF LAND TR	2891403
08/19/2013	669	LAND STATUS CHECKED		
07/10/2013	669	LAND STATUS CHECKED		
05/17/2013	501	ACCT ADV IN LEAD FILE	AMC423142-AMC423144;	

Line Nr Remarks

**DEPARTMENT OF THE INTERIOR  
BUREAU OF LAND MANAGEMENT  
MINING CLAIMS**

**(LIVE) Serial Register Page**

Run Date/Time: 02/11/2015 08:20 AM

Page 29 of 41

01 05-10-1872;017STAT0091;30USC26,28,34

Case Type 384101: LODE CLAIM

Claim Name: SAMOA EAST

Commodity :

Case Disposition: ACTIVE

Required Maintenance Fee: \$155.00

*LTR 41*

Total Acres  
20.660

Serial Number  
AMC423144  
Lead File Number  
AMC423142

Name & Address	Int Rel
DOUGLAS DIAMONDS CORP 1300 N CHARLOTTE ST POTTSTOWN, PA 19464-2351	CLAIMANT

Mer Twp	Rng	Sec	Quadrant	District/Field Office	County
14	0230N	0170W	006	SW KINGMAN FO	MOHAVE
14	0230N	0180W	001	SE KINGMAN FO	MOHAVE

Act Date	Code	Action	Action Remarks	Receipt Number
04/28/2013	403	LOCATION DATE		
05/17/2013	395	RECORDATION NOTICE RECD	1	2796637
08/28/2014	483	SMALL MINER CERT FILED	2015	
08/30/2013	682	MAINTENANCE FEE/\$140	✓2014;\$140	2871074
05/17/2013	484	LOCATION YEAR / MAINTENANCE	2013;\$140	2796637
09/17/2013	396	TRF OF INTEREST FILED	DEPARTMENT OF LAND TR	2891403
08/19/2013	669	LAND STATUS CHECKED		
07/10/2013	669	LAND STATUS CHECKED		
05/17/2013	501	ACCT ADV IN LEAD FILE	AMC423142-AMC423144;	

*Switched from MF to  
WVR - Missing 2014 Nos  
- NO NOS -*

Line Nr Remarks



# MINING CLAIM STATUS REPORT

DATA ENTERED JUN 17 2013 *ps*

MTP Checked by JUN 17 2013 *ps*

GEO Checked by JUN 17 2013 *ps*

LEAD SERIAL NUMBER AMC 423142 thru AMC 423144

### # OF CLAIMS & TYPE

# 3 LODE  
 # \_\_\_\_\_ PLACER  
 # \_\_\_\_\_ ASSOCIATION PLACER  
 # \_\_\_\_\_ MILL SITE  
 # \_\_\_\_\_ TUNNEL SITE

### CHARGES

Location Fee @ \$34 = \$ 102.00  
 Processing Fee @ \$15 = \$ 45.00  
 Maintenance Fee @ \$140 = \$ 420.00  
 Overage (+) \$ \_\_\_\_\_  
 Shortage (-) \$ \_\_\_\_\_  
 Other Fees \$ \_\_\_\_\_  
**TOTAL \$ 567.00**

TOTAL CLAIM ACREAGE? \_\_\_\_\_

# OF LOCATORS? \_\_\_\_\_

### DOCUMENTS RECEIVED VIA -

Over-the-Counter [ ] Mail [ ]

### TIMELY FILED?

Yes [ ] No [ ]

LEGAL DESCRIPTION - T 23N R 18W SEC 1,2  
 T 23N R 17W SEC 6  
 T \_\_\_\_\_ R \_\_\_\_\_ SEC \_\_\_\_\_  
 T \_\_\_\_\_ R \_\_\_\_\_ SEC \_\_\_\_\_

BLM [ ] FOREST SERVICE [ ] \_\_\_\_\_ SUBJ TO PL 359: Yes [ ] No [ ]

WILDERNESS AREA: No [ ] Yes [ ] \_\_\_\_\_

SPLIT ESTATE - N/A [ ] SX [ ] PX [ ] SRHA [ ] OTHER [ ] \_\_\_\_\_

Proper Notice Filed if Located on SHRA Lands? N/A [ ] Yes [ ] No [ ]

### RECONVEYED MINERALS ON BLM LANDS REQUIRE OPENING ORDERS FROM 1944 TO 1993 -

Open to Entry on: \_\_\_\_\_ N/A [ ]

COMMENTS/STATUS - VOID [ ] PARTIALLY VOID [ ] PVT MINERALS [ ] WITHDRAWN LANDS [ ]

OTHER [ ] AMC 423144 overlaps patented land. No right acquired, AMC 423143 overlaps stoll surface & mins. No rights acquired.

AMC 423142

Claimant acknowledges that portions of the following claims(s) site(s) may be void or voidable.

Printed Name of Claimant \_\_\_\_\_ Signature of Claimant \_\_\_\_\_

\*\*\*\*\* FINAL ADJUDICATION \*\*\*\*\*

DATE 8/19/2013 INITIALS [Signature]

RECORDING REQUESTED BY:

(Mail recording to;)

Department of Land

Transfer Information, Inc.

942 Calle Amanecer, Suite B

San Clemente, CA 92673

FOR RECORDER'S USE

**LOCATION NOTICE FOR LODE MINING CLAIM**

NOTICE IS HEREBY GIVEN that the **BUTCH** lode mining claim has been located by Department of Land Transfer Information, Inc., a Wyoming Corporation whose current mailing address is 942 Calle Amanecer, Suite B, San Clemente, CA 92673.

The general course of this claim is North and South and it is situated in the Gila Salt River Meridian, Mohave County, Arizona.

This claim is 1,500 feet in length and 600 feet in width. This claim runs from the location monument on which this location notice is posted approximately 1,200 feet in a Northerly direction to the North end line and approximately 300 feet in a Southerly direction to the South end line.

This claim is marked by four (4) monuments, one at each corner of the claim. Additionally, there are two (2) end-line markers on each side of the center of the claim. All markers are 4" x 4" wooden posts that are buried 1.5' in the ground and protrude 4.5' above the ground embossed with the name of the claim and its location in relation to the claim.

The location monument on which this notice is posted is situated within Section 1, Township 23N, Range 18W, Gila Salt River Meridian, Mohave County Arizona and this claim encompasses portions of the following quarter section (s), Township (s) and Range (s); NE 1/4 of SE 1/4 / L27, NW 1/4 of SE 1/4, L28, SE 1/4 of SE 1/4, L31 and SW 1/4 of SE 1/4 Section 1, T23N, R18W, Gila Salt River Meridian, Mohave County Arizona.

The locality of this claim with reference to some natural object or permanent monument and additional information (if any) concerning its locality are as follows: SE corner of this claim is 980 Feet West and 220 Feet North of the SE corner of Section 1, T23N, R18W.

DATED AND POSTED on the ground this 28<sup>th</sup> day of April, 2013.

Locator of this lode mining claim is:

**DEPARTMENT OF LAND TRANSFER INFORMATION, INC.**

Steven L. Cyros, President

Authorized Officer for DEPARTMENT OF LAND TRANSFER INFORMATION, INC.

BLM Date Stamp	RECEIVED BLM AZ STATE OFFICE MAY 17 P 2:19 GLENDALE, ARIZONA
----------------------	---

AN10123142

# MINING CLAIM MAP

- 1) Name of Claim; **BUTCH**
- 2) Type if Claim; **LODE**
- 3) Location Monument is located in Section 1, Township 23N, Range 18W, Gila-Salt River Meridian, Mohave County, Arizona.
- 4) The types of corner and location monuments used are as follows: 4" X 4" Wooden Posts.

Lode Mining Claim Butch, Chloride Mining District, Mohave County, Arizona

114.16667° W                      114.15000° W                      WGS84 114.13333° W

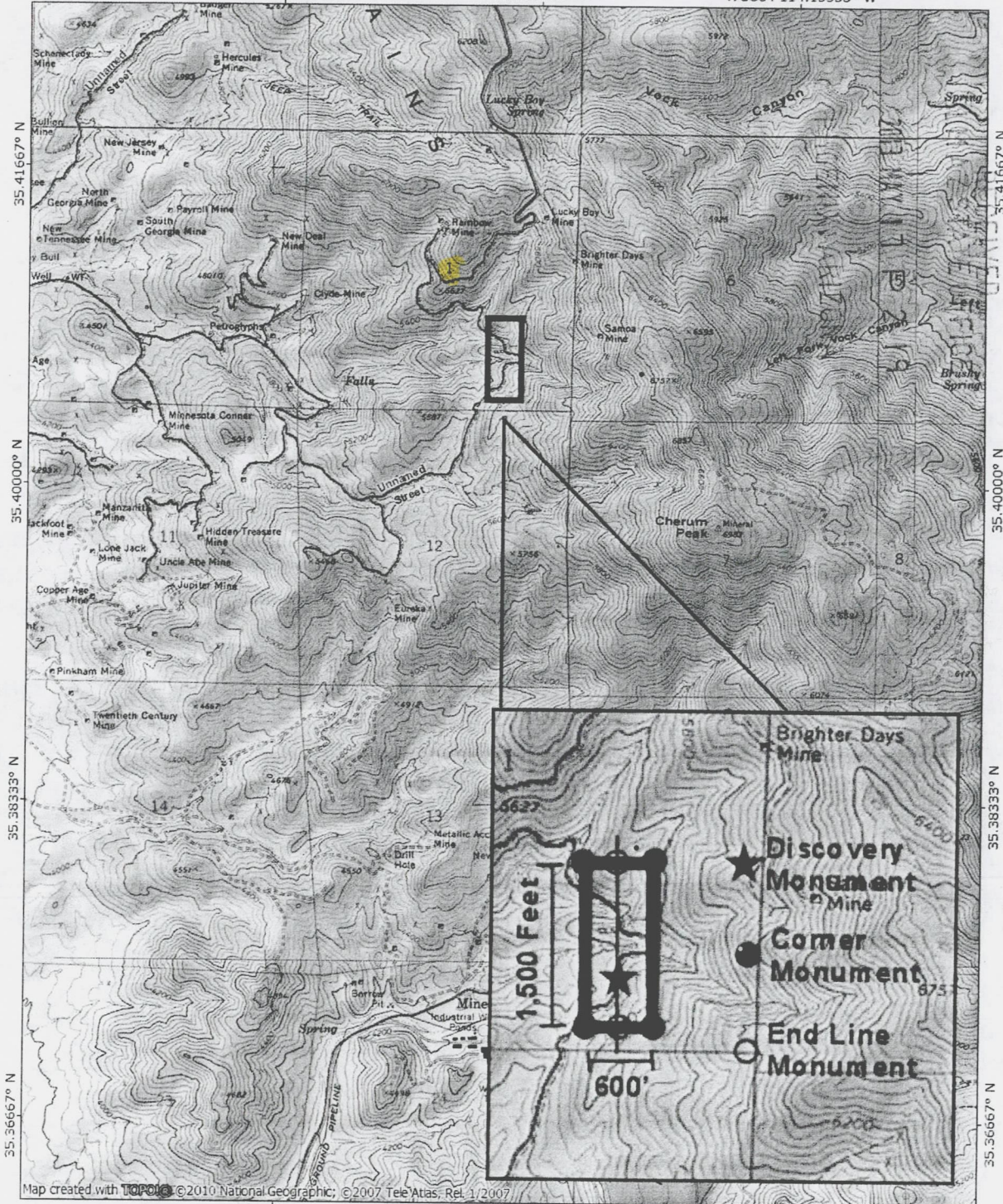

Map created with TOPOLIC © 2010 National Geographic; © 2007 Tele Atlas, Rel. 1/2007

114.16667° W                      114.15000° W                      WGS84 114.13333° W

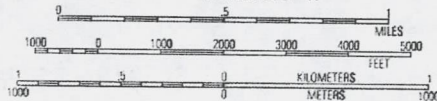

TN MN  
11 1/2°  
04/30/13

AN04231421

RECORDING REQUESTED BY:

(Mail recording to:)

Department of Land

Transfer Information, Inc.

942 Calle Amanecer, Suite B

San Clemente, CA 92673

FOR RECORDER'S USE

**LOCATION NOTICE FOR LODE MINING CLAIM**

NOTICE IS HEREBY GIVEN that the **CLYDE** lode mining claim has been located by Department of Land Transfer Information, Inc., a Wyoming Corporation whose current mailing address is 942 Calle Amanecer, Suite B, San Clemente, CA 92673.

The general course of this claim is North and South and it is situated in the Gila Salt River Meridian, Mohave County, Arizona.

This claim is 1,500 feet in length and 600 feet in width. This claim runs from the location monument on which this location notice is posted approximately 1,200 feet in a Northerly direction to the North end line and approximately 300 feet in a Southerly direction to the South end line.

This claim is marked by four (4) monuments, one at each corner of the claim. Additionally, there are two (2) end-line markers on each side of the center of the claim. All markers are 4" x 4" wooden posts that are buried 1.5' in the ground and protrude 4.5' above the ground embossed with the name of the claim and its location in relation to the claim.

The location monument on which this notice is posted is situated within Section 1, Township 23N, Range 18W, Gila Salt River Meridian, Mohave County Arizona and this claim encompasses portions of the following quarter section (s), Township (s) and Range (s); SW 1/4 of NW 1/4 Section 1, NW 1/4 of SW 1/4 Section 1, T23N, R18W, SE 1/4 of NE 1/4 Section 2 and of NE 1/4 of SE 1/4 Section 2, T23N, R18W, Gila Salt River Meridian, Mohave County Arizona.

The locality of this claim with reference to some natural object or permanent monument and additional information (if any) concerning its locality are as follows: NW corner of this claim is 95 Feet West and 645 Feet South of the NW corner of SW 1/4 of NW 1/4 Section 1, T23N, R18W.

DATED AND POSTED on the ground this 28<sup>th</sup> day of February, 2013.

Locator of this lode mining claim is:

**DEPARTMENT OF LAND TRANSFER INFORMATION, INC.**

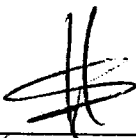

Steven L. Cyros, President

Authorized Officer for DEPARTMENT OF LAND TRANSFER INFORMATION, INC.

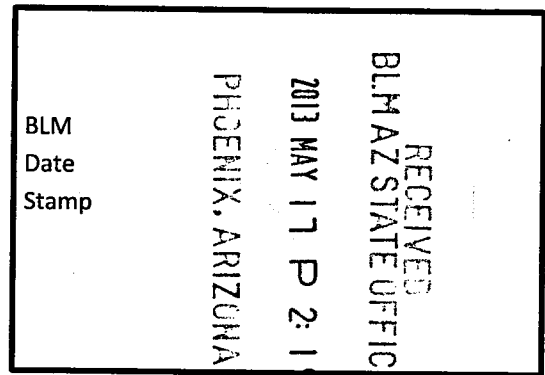

AN0023103

# MINING CLAIM MAP

- 1) Name of Claim; **CLYDE**
- 2) Type if Claim; **LODE**
- 3) Location Monument is located in Section 1, Township 23N, Range 18W, Gila-Salt River Meridian, Mohave County, Arizona.
- 4) The types of corner and location monuments used are as follows: 4" X 4" Wooden Posts.

Lode Mining Claim Clyde, Chloride Mining District, Mohave County, Arizona  
 114.18333° W      114.16667° W      WGS84 114.15000° W

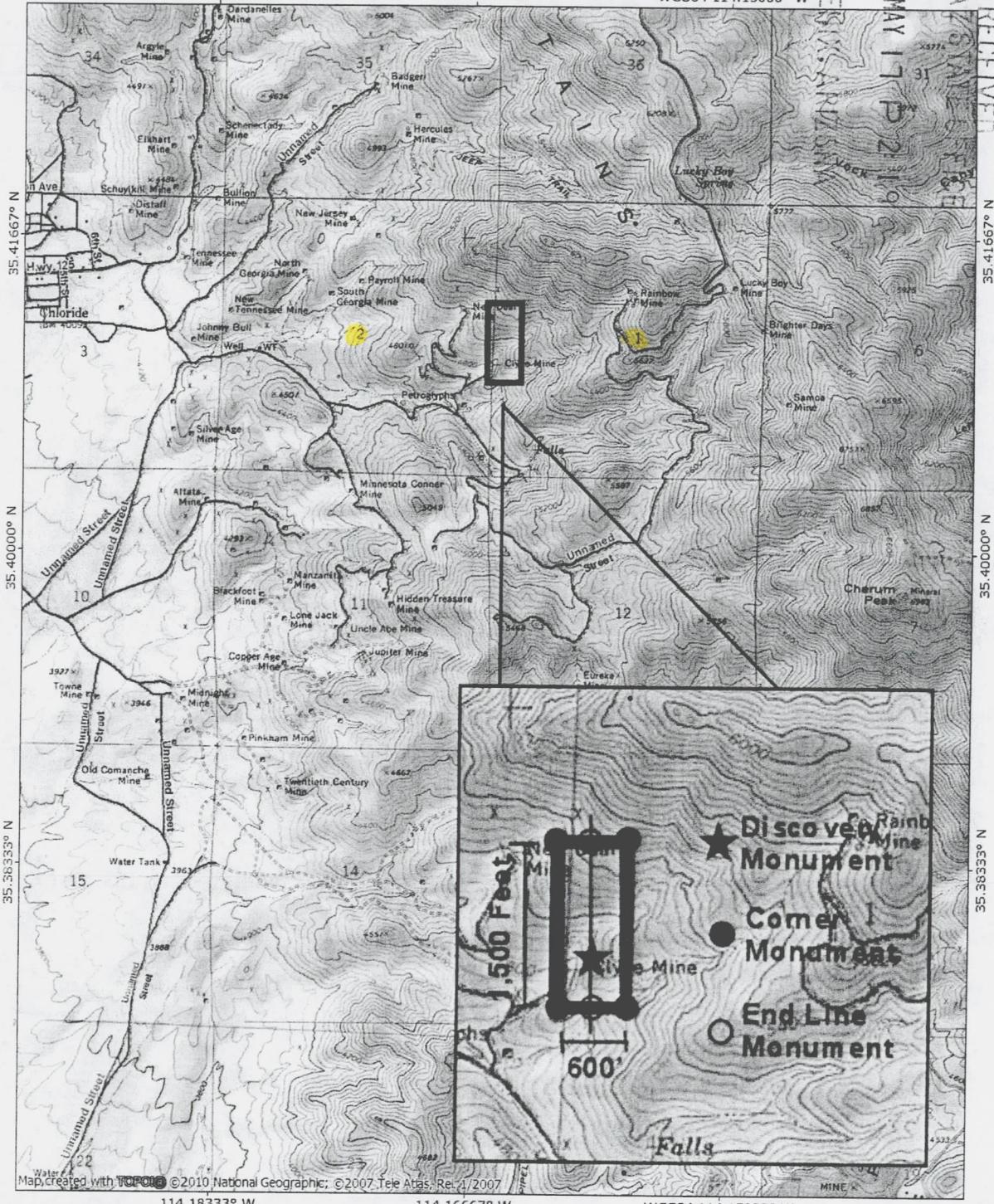

Map created with TOPOID © 2010 National Geographic; © 2007 Tele Atlas; Re: 4/2007

114.18333° W      114.16667° W      WGS84 114.15000° W

**NATIONAL GEOGRAPHIC**

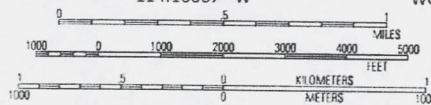

TN \* MN  
 11 1/2°  
 04/30/13

RECEIVED  
 BLM ARIZONA  
 2013 MAY 17 P 2:10  
 PIERRE, ARIZONA

ANCH23143

RECORDING REQUESTED BY:

(Mail recording to;)

Department of Land

Transfer Information, Inc.

942 Calle Amanecer, Suite B

San Clemente, CA 92673

FOR RECORDER'S USE

**LOCATION NOTICE FOR LODE MINING CLAIM**

RECEIVED BLM AZ STATE OFFICE	2013 MAY 17 P 2:19	PHOENIX, ARIZONA
BLM	Date	Stamp

NOTICE IS HEREBY GIVEN that the **SAMOA EAST** lode mining claim has been located by Department of Land Transfer Information, Inc., a Wyoming Corporation whose current mailing address is 942 Calle Amanecer, Suite B, San Clemente, CA 92673.

The general course of this claim is East and West and it is situated in the Gila Salt River Meridian, Mohave County, Arizona.

This claim is 1,500 feet in length and 600 feet in width. This claim runs from the location monument on which this location notice is posted approximately 1,200 feet in an Easterly direction to the East end line and approximately 300 feet in a Southerly direction to the South end line.

This claim is marked by four (4) monuments, one at each corner of the claim. Additionally, there are two (2) end-line markers on each side of the center of the claim. All markers are 4" x 4" wooden posts that are buried 1.5' in the ground and protrude 4.5' above the ground embossed with the name of the claim and its location in relation to the claim.

The location monument on which this notice is posted is situated within Section 1, Township 23N, Range 18W, Gila Salt River Meridian, Mohave County Arizona and this claim encompasses portions of the following quarter section (s), Township (s) and Range (s); NE 1/4 of SE 1/4 Section 1, T23N, R18W, SE 1/4 of SE 1/4 Section 1, T23N, R18W, NW 1/4 of SW 1/4 Section 6, T23N, R17W and SW 1/4 of SW 1/4 Section 6, T23N, R17W, Gila Salt River Meridian, Mohave County Arizona.

The locality of this claim with reference to some natural object or permanent monument and additional information (if any) concerning its locality are as follows: SW corner of this claim is 920 Feet North and 870 Feet West of the SE corner of Section 1, T23N, R18W.

DATED AND POSTED on the ground this 28<sup>th</sup> day of April, 2013.

Locator of this lode mining claim is:

**DEPARTMENT OF LAND TRANSFER INFORMATION, INC.**

Steven L. Cyros, President

Authorized Officer for DEPARTMENT OF LAND TRANSFER INFORMATION, INC.

APR 23 1 44

# MINING CLAIM MAP

- 1) Name of Claim; **SAMOA EAST**
- 2) Type if Claim; **LODE**
- 3) Location Monument is located in Section 1, Township 23N, Range 18W, Gila-Salt River Meridian, Mohave County, Arizona.
- 4) The types of corner and location monuments used are as follows: 4" X 4" Wooden Posts.

Lode Mining Claim Samoa, Chloride Mining District, Mohave County, Arizona  
 114.16667° W                      114.15000° W                      WGS84 114.13333° W

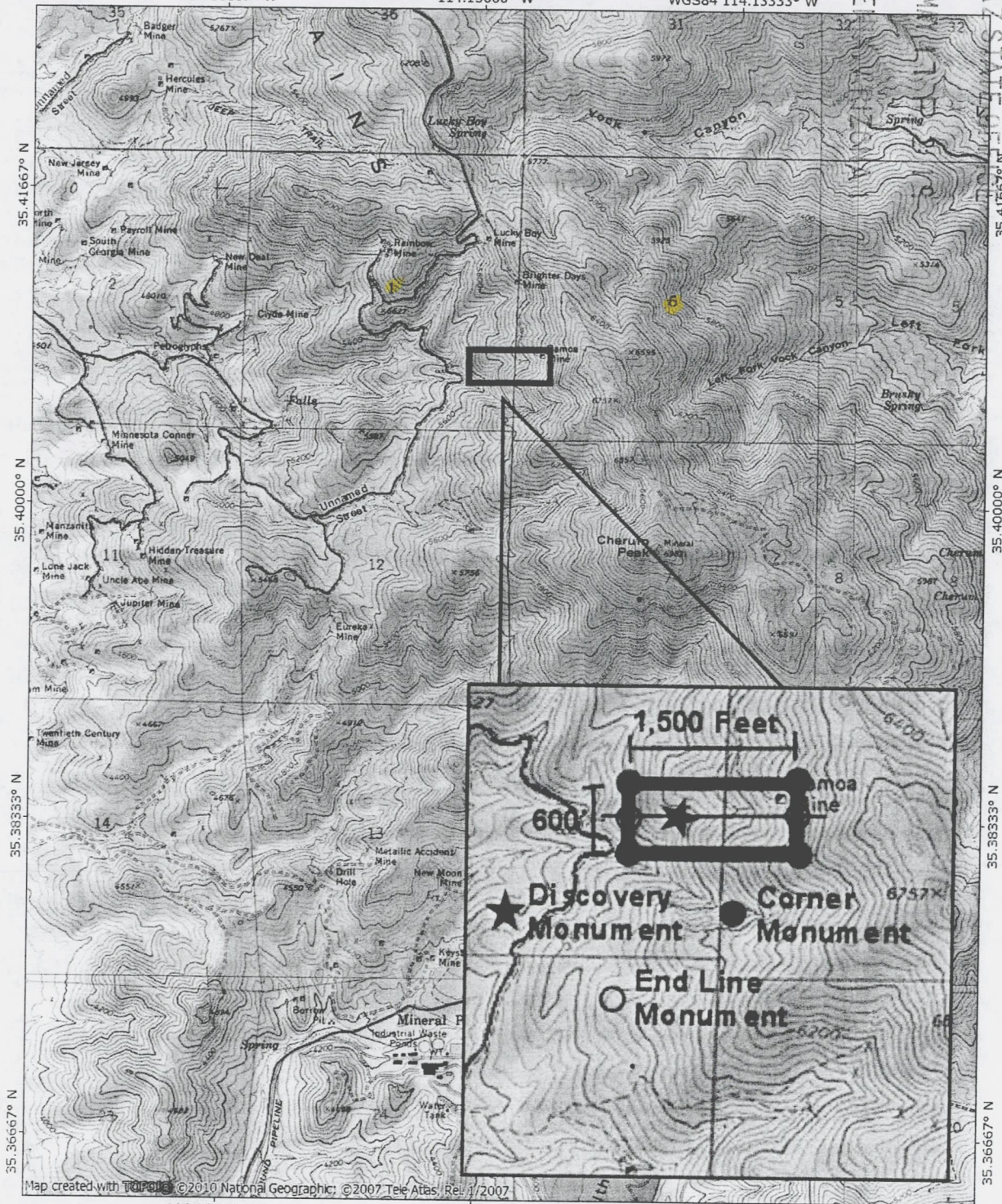

Map created with TopoTools © 2010 National Geographic; © 2007 Tele Atlas, Re. 1/2007

114.16667° W                      114.15000° W                      WGS84 114.13333° W

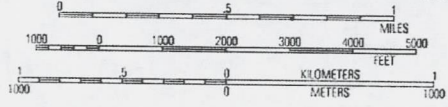

TN MN  
 11 1/2°  
 05/01/13

RECEIVED  
 DLMAZ STATE DEPT  
 2013 MAR 11 10:51 AM  
 PHOTO

AN0423144



DEPARTMENT OF LAND TRANSFER INFORMATION  
PROTECTING AMERICA'S RESOURCES

STEVEN L. CYROS  
SUPERVISORY FIELD AGENT

942 CALLE AMANEGER  
BLDG. B / MS 548  
SAN CLEMENTE, CA 92673  
TEL (949) 366-9484  
FAX (949) 366-9945  
SCYROS@DLTI.US.COM  
WWW.LANDTRANSFER.US.COM

May 16, 2013

Bureau of Land Management  
Arizona State Office  
One Central Avenue  
Suite 800  
Phoenix, AZ 85004-4427

RECEIVED  
BLM AZ STATE OFFICE  
2013 MAY 17 P 2:19  
PHOENIX, ARIZONA

RE: Location Notices/Filings for Mining Claim and payment on the following new placer Mining Claims;

1. CLYDE Lode Mining Claim
2. BUTCH Lode Mining Claim
3. SAMOA EAST Lode Mining Claim

To Whom It May Concern:

Enclosed, please find my check payable to Department of the Interior/BLM for payment in the amount of \$567.00 for the processing of the following three (3) location notices/lode mining claims (3 claims X \$189.00/Each), as well as the signed location notices dated on February 28<sup>th</sup> of 2013 and a copy of the respective location maps.

Should you need any additional information, please do not hesitate to call on me.

Warmest Regards,

Steven L. Cyros, President

AMC423142



**Extremely Urgent**

RECEIVED  
BLMAZ STATE OFFICE

2013 MAY 17 P 2:20

This envelope is for use with the following services:

**UPS Next Day Air®**  
**UPS Worldwide Express®**  
**UPS 2nd Day Air®**

Visit **ups.com®** or call **1-800-PICK-UPS®** (1-800-742-5877) to schedule a pickup or find a drop off location near you.

**Domestic Shipments**

- To qualify for the Letter rate, UPS Express Envelopes may only contain correspondence, urgent documents, and/or electronic media, and must weigh 8 oz. or less. UPS Express Envelopes containing items other than those listed or weighing more than 8 oz. will be billed by weight.

**International Shipments**

- The UPS Express Envelope may be used only for documents of no commercial value. Certain countries consider electronic media as documents. Visit [ups.com/importexport](http://ups.com/importexport) to verify if your shipment is classified as a document.
- To qualify for the Letter rate, the UPS Express Envelope must weigh 8 oz. or less. UPS Express Envelopes weighing more than 8 oz. will be billed by weight.

**Note:** Express Envelopes are not recommended for shipments of electronic media containing sensitive personal information or breakable items. Do not send cash or cash equivalent.

Apply shipping documents on this side.

Do not use this envelope for:

LTR 1 OF 1

STEVEN CYROS  
(949) 366-9484  
FTF TECHNOLOGIES, INC.  
942 CALLE AMANECER, SUITE B  
SAN CLEMENTE CA 92673-6220

**SHIP TO:**

**BUREAU OF LAND MANAGEMENT**  
**(602) 417-9200**  
**ARIZONA STATE OFFICE**  
**SUITE 800**  
**ONE NORTH CENTRAL AVENUE**  
**PHOENIX AZ 85004-4427**

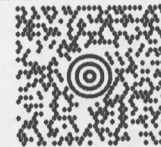

**AZ 850 9-10**



**UPS NEXT DAY AIR SAVER 1P**

TRACKING #: 1Z 614 Y2R 13 6782 8590

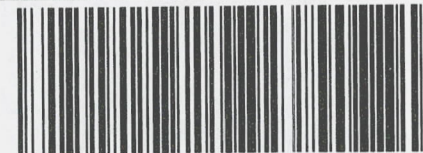

BILLING: P/P

HS 16.0.31

39.00 04/2013

SEE BACK OF ENVELOPE regarding UPS terms, and nature of limitations of liability. Where allowed by law, shipper authorizes UPS to act as forwarding agent for export control and customs purposes. If required from the U.S., shipper certifies that the commodities, technology or software were exported from the U.S. in accordance with the Export Administration Regulations. Diversion contrary to law is prohibited.

International Shipping Notice — Carriage hereunder may be subject to the rules relating to liability and other terms and/or conditions established by the Convention for the Unification of Certain Rules Relating to International Carriage by Air (the "Warsaw Convention") and/or the Convention on the Contract for the International Carriage of Goods by Road (the "CMR Convention"). These commodities, technology or software were exported from the U.S. in accordance with the Export Administration Regulations. Diversion contrary to U.S. law prohibited.

010195101 1/10 IP United Parcel Service, Louisville, KY

100% Recycled fiber  
80% Post-Consumer



# Express Envelope

Synchronizing the world of commerce <sup>SM</sup>



ARIZONA STATE OFFICE  
1 N CENTRAL AVE  
STE 800  
PHOENIX AZ 85004-4414

P: PURPLE S: ORANGE I: 43D

0905-6070

12614Y2R136782 8590

1500

SAT08485 MAY 17 07:20:37 2013  
US 9501 HIPPS 12.1.6 SAT08485aL

RUN TIME: 08:26 AM

Adm State: AZ

UNITED STATES DEPARTMENT OF INTERIOR  
BUREAU OF LAND MANAGEMENT  
GEOGRAPHIC REPORT WITH LAND  
Sorted by Meridian Township Range

RUN DATE: 06/17/2013

Page 1 of 1

Serial Number: AZA 007017  
Total Case Acres: 378.790

<u>Casetype</u>	<u>Case Disp</u>	<u>14</u>	<u>0230N</u>	<u>0180W</u>	<u>Sect</u>	<u>Sur Typ</u>	<u>Sur Num</u>	<u>Suff</u>	<u>Subdivision</u>	<u>Act Pend</u>
281008	AUTHORIZED				001	LOTS			17,25;	

Serial Number: AZA 019995  
Total Case Acres: 4.876

<u>Casetype</u>	<u>Case Disp</u>	<u>14</u>	<u>0230N</u>	<u>0180W</u>	<u>Sect</u>	<u>Sur Typ</u>	<u>Sur Num</u>	<u>Suff</u>	<u>Subdivision</u>	<u>Act Pend</u>
285003	AUTHORIZED				001	LOTS			19;	

Serial Number: AZA 028681  
Total Case Acres: 5.210

<u>Casetype</u>	<u>Case Disp</u>	<u>14</u>	<u>0230N</u>	<u>0180W</u>	<u>Sect</u>	<u>Sur Typ</u>	<u>Sur Num</u>	<u>Suff</u>	<u>Subdivision</u>	<u>Act Pend</u>
286001	AUTHORIZED				001	MNR		1	SWSWSW;	

Serial Number: AZPHX 0034352  
Total Case Acres: 424.177

<u>Casetype</u>	<u>Case Disp</u>	<u>14</u>	<u>0230N</u>	<u>0180W</u>	<u>Sect</u>	<u>Sur Typ</u>	<u>Sur Num</u>	<u>Suff</u>	<u>Subdivision</u>	<u>Act Pend</u>
285003	AUTHORIZED				001	ALIQ LOTS			S2SW,SWSE; 31;	

DEPARTMENT OF INTERIOR  
BUREAU OF LAND MANAGEMENT

Input Parameters for Geographic Report with Land

System Id = CR

Admin State = AZ

Geo State = AZ

Casetype Begins With

Case Disp Txt = AUTHORIZED, CANCELLED, EXPIRED, PENDING, REJECTED, RELINQUISHED, WITHDRAWN

Mer Twp Rng =

Section =

Mtrs = 14 0230N 0170W 006, 14 0230N 0170W 999, 14 0230N 0180W 001, 14 0230N 0180W 002, 14 0230N 0180W 999

Commodity =

Commodity Txt =

Pending Org =

Pend Org Decode =

Total Rows Returned: 5







